

VALVOLE PNEUMATICHE

- Di solida e robusta costruzione e di facile e veloce accesso per le operazioni di pulizia.
- Parti a contatto con il fluido costruite esclusivamente in acciaio inossidabile AISI 316L.
- Corredabili di comandi manuali o pneumatici.
- Comandi manuali dotati di vite a passo rapido con sicurezza di svitamento.
- Comandi pneumatici a doppio effetto o semplice effetto, corredabili di contatto di prossimità, microinterruttore (elettrico o pneumatico), elettrovalvola (24 V CA, 24 V CC, 48 V CA, 110 V CA, 110 V CC), connettore.
- Entrata aria nella testata superiore della valvola e distribuzione nella parte inferiore tramite il pistone interno.
- Assoluta sicurezza durante le operazioni di montaggio e smontaggio garantita da uno speciale dispositivo per il costante contenimento in compressione delle molle.
- Ampia gamma di otturatori e guarnizioni disponibili per le specifiche esigenze degli impianti: otturatore con guarnizione a labbro; otturatore con guarnizione a soffietto; guarnizione a doppio labbro (standard silicone; a richiesta, EPDM o FTM); guarnizione metallica con OR; guarnizione metallica per sterilizzazione a vapore; guarnizione metallica con compensazione di usura. Esecuzione standard: otturatore con guarnizione a labbro; guarnizione a doppio labbro.
- Finitura standard: lucidatura esterna e satinatura interna grana 120.
- Max. pressione di esercizio: 4 bar.

PNEUMATIC VALVES

- Heavy duty construction and easy, fast access for cleaning operations.
- Parts in contact with the fluid made exclusively of AISI 316L stainless steel.
- Can be equipped with manual or pneumatic controls.
- Manual controls with fast-pitch screw with safe unscrewing.
- Double- and single-effect pneumatic controls. Can be equipped with proximity contact, microswitch (electric or pneumatic), solenoid valve (24 V AC, 24 V DC, 48 V AC, 110 V AC, 110 V DC), connector.
- Air entry into the upper head of the valve and distribution in the lower part by an internal piston.
- Absolute safety during assembly and disassembly, ensured by a special device to keep the springs under constant compression.
- Wide range of shutters and gaskets available for specific system requirements. Shutter with lip gasket; shutter with bellows gasket; two-lip gasket (silicone standard; EPDM or FTM on request); metallic gasket with OR; metallic gasket for steam sterilization; metallic gasket with wear compensation. Standard features: shutter with lip gasket; two-lip gasket.
- Standard finish: 120 grain external polishing and internal glazing.
- Maximum operating pressure: 4 bars.

VANNES PNEUMATIQUES

- Fabrication solide et robuste. Accès facile et rapide pour les opérations de nettoyage.
- Parties en contact avec le fluide fabriquées exclusivement en acier inoxydable AISI 316L.
- Peuvent être munies avec commandes manuelles ou pneumatiques.
- Commandes manuelles munies de vis à pas rapide avec dévissage sûr.
- Commandes pneumatiques à double effet ou simple effet. Elles peuvent être munies de contact de proximité, minirupteur (électrique ou pneumatique), électrovanne (24 V CA, 24 V CC, 48 V CA, 110 V CA, 110 V CC), connecteur.
- Admission de l'air par la partie supérieure de la vanne et refoulement dans la partie inférieure à l'aide du piston interne.
- Sécurité absolue au cours des opérations de montage et démontage grâce à un dispositif spécial assurant le maintien constant sous compression des ressorts.
- Vaste gamme d'obturateurs et de joints disponibles pour les exigences spécifiques des installations: obturateur avec joint à lèvres; obturateur avec joint à soufflet; joint à deux lèvres (standard silicone; sur demande, EPDM ou FTM); joint métallique avec OR; joint métallique pour stérilisation à vapeur; joint métallique avec compensation d'usure. Exécution standard: obturateur avec joint à lèvres; joint à deux lèvres.
- Finissage standard: polissage extérieur et satinage intérieur grain 120.
- Pression d'exploitation maximum: 4 bars.

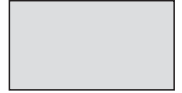
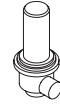

VÁLVULAS NEUMÁTICAS

- De sólida y robusta construcción y de fácil y rápido acceso para las operaciones de limpieza.
- Las partes que están en contacto con el fluido se fabrican exclusivamente en acero inoxidable AISI 316L.
- Equipadas con mandos manuales o neumáticos.
- Mandos manuales dotados de tornillo de paso rápido con seguridad de desenroscado.
- Mandos neumáticos de doble efecto o simple efecto que se pueden equipar con microsensor, microrruptor (eléctrico o neumático), electroválvula (24 V CA, 24 V CC, 48 V CA, 110 V CA, 110 V CC), conector.
- Entrada de aire por la parte superior de la válvula y distribución en la parte inferior mediante el pistón interno.
- Absoluta seguridad durante las operaciones de montaje y desmontaje, garantizada por un dispositivo especial que permite mantener constantemente bajo compresión los muelles.
- Amplia gama de obturadores y juntas disponibles para las exigencias específicas de las instalaciones: obturador con junta de reborde; obturador con junta de fuelle; junta de reborde doble (estándar silicona; a pedido, EPDM o FTM); junta metálica con OR; junta metálica para esterilización con vapor; junta metálica con compensación de desgaste. Ejecución estándar: obturador con junta de reborde; junta de reborde doble.
- Acabado estándar: pulido exterior y satinado interior grano 120.
- Máxima presión de ejercicio: 4 bares.

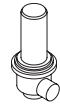

VALVOLA PNEUMATICA VANNE PNEUMATIQUE
PNEUMATIC VALVE VÁLVULA NEUMÁTICA

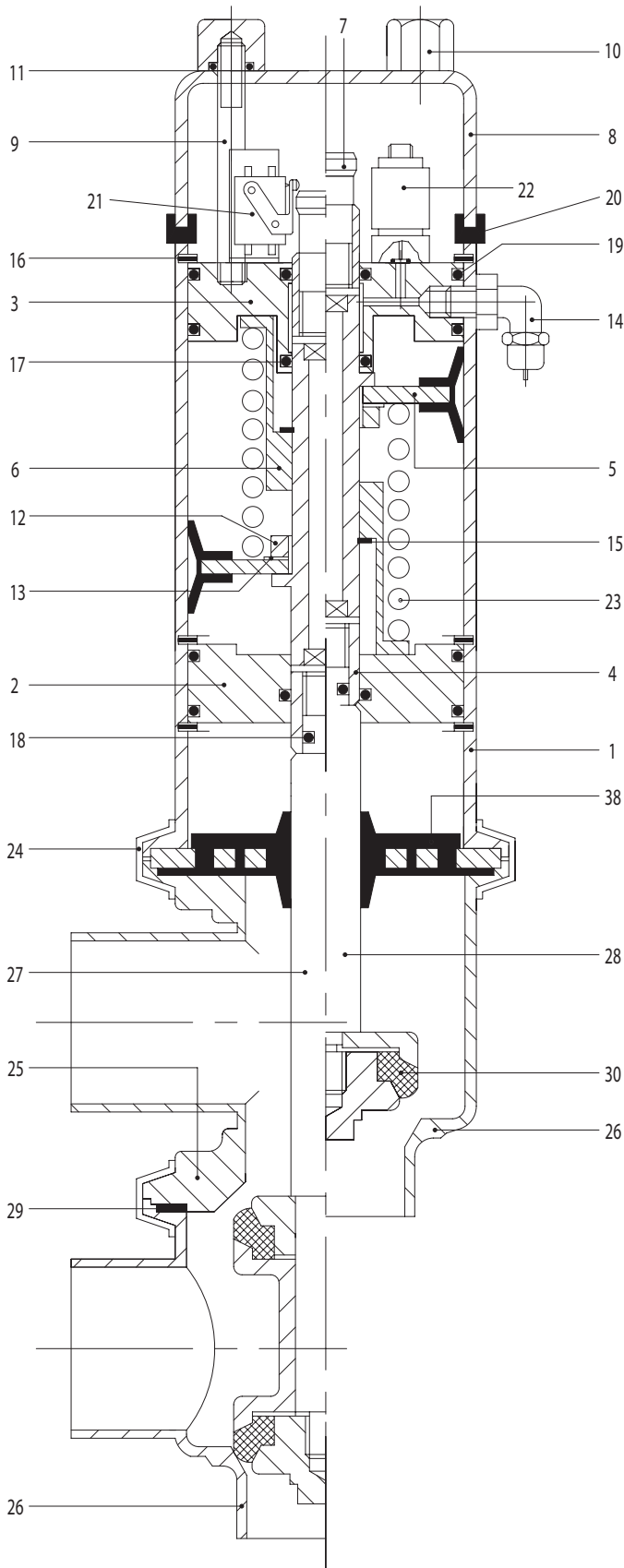

- | | |
|---|--|
| 1. Cilindro
Cylinder
Cylindre
Cilindro | 17. Anello di tenuta OR
OR seal ring
Joint torique
Junta OR |
| 2. Testata inferiore
Bottom head
Tête inférieure
Cabezal inferior | 18. Anello di tenuta OR
OR seal ring
Joint torique
Junta OR |
| 3. Testata superiore
Top head
Tête supérieure
Cabezal superior | 19. Anello di tenuta OR
OR seal ring
Joint torique
Junta OR |
| 4. Pistone
Piston
Piston
Pistón | 20. Guarnizione cappello
Cap seal
Joint capot
Junta capuchón |
| 5. Guarnizione a labbro
Lip gasket
Joint à lèvres
Junta de reborde | 21. Microinterruttore
Microswitch
Minirupteur
Microrruptor |
| 6. Distanziale
Distance piece
Entretoise
Distanciador | 22. Elettrovalvola
Solenoid valve
Électrovanne
Electroválvula |
| 7. Perno microinterruttore
Microswitch rod
Came minirupteur
Perno microrruptor | 23. Molla
Spring
Ressort
Muelle |
| 8. Cappello
Cap
Capot
Capuchón | 24. Collare
Collar
Collier
Collarín |
| 9. Tirante
Tie rod
Tirant
Tirante | 25. Corpo intermedio
Middle body
Corps intermédiaire
Cuerpo intermedio |
| 10. Dado
Nut
Écrou
Tuerca | 26. Corpo inferiore
Lower body
Corps inférieur
Cuerpo inferior |
| 11. Anello di tenuta OR
OR seal ring
Joint torique
Junta OR | 27. Otturatore v. pn. 3 vie
Shutter 3-way pn. v.
Obturateur v. pn. 3 voies
Obturador v. n. 3 vías |
| 12. Ghiera di bloccaggio
Locking collar
Douille de blocage
Tuerca de seguridad | 28. Otturatore v. pn. 2 vie
Shutter 2-way pn. v.
Obturateur v. pn. 2 voies
Obturador v. n. 2 vías |
| 13. Rondella di sicurezza
Safety washer
Rondelle de sûreté
Arandela de seguridad | 29. Guarnizione
Seal
Joint
Junta |
| 14. Raccordo aria
Air union
Raccord air
Racor del aire | 30. Guarnizione a labbro
Lip gasket
Joint à lèvres
Junta de reborde |
| 15. Seeger
Snap ring
Circlips
Anillo seeger | 38. Guarniz. doppio labbro
Two-lip gasket
Joint à deux lèvres
Junta de reborde doble |
| 16. Seeger
Snap ring
Circlips
Anillo seeger | |

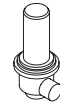

VALVOLA MANUALE
MANUAL VALVE

VANNE MANUELLE
VÁLVULA MANUAL

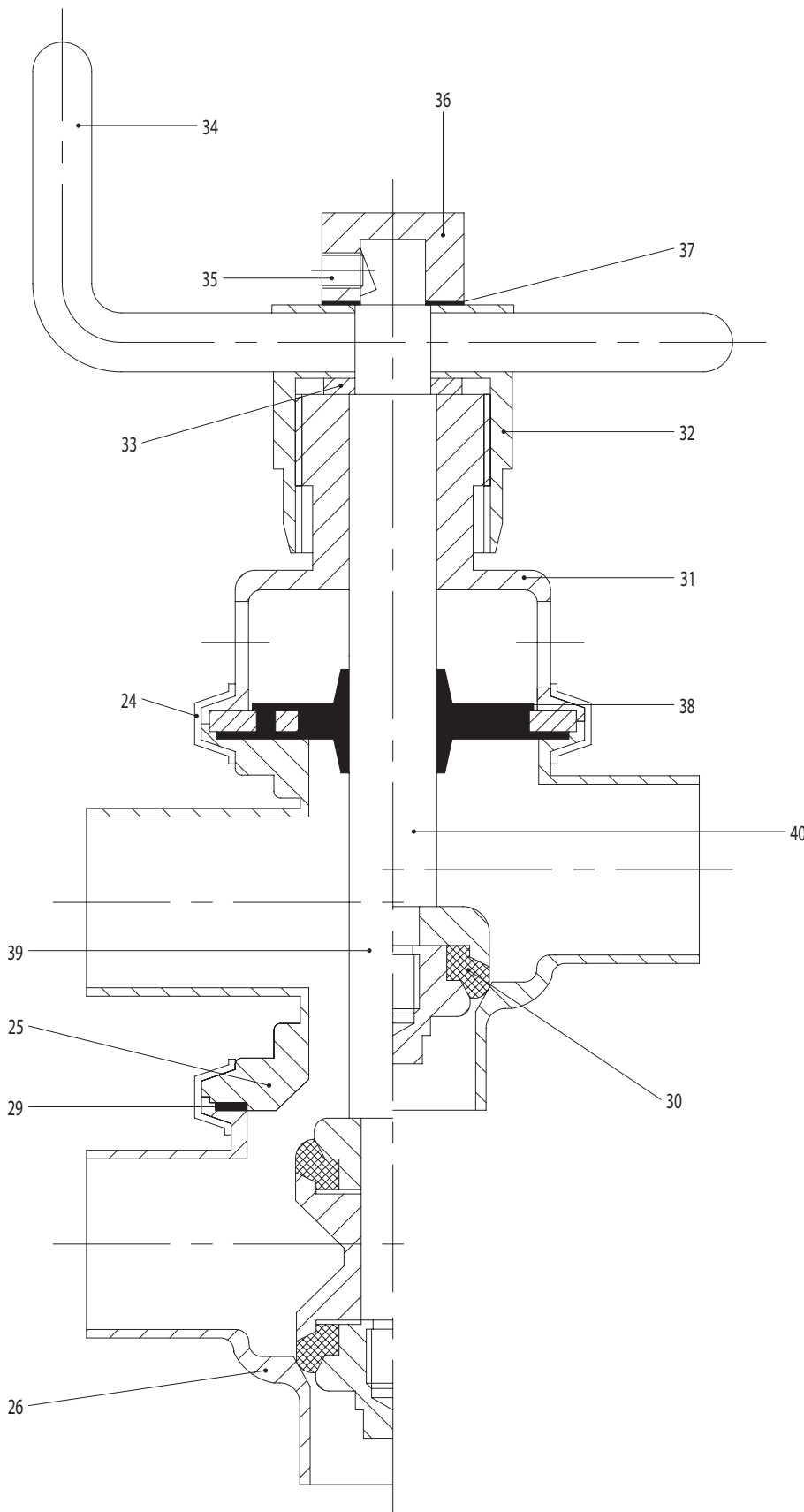

- 24. Collare
Collar
Collier
Collarín
- 25. Corpo intermedio
Middle body
Corps intermédiaire
Cuerpo intermedio
- 26. Corpo inferiore
Lower body
Corps inférieur
Cuerpo inferior
- 29. Guarnizione
Seal
Joint
Junta
- 30. Guarnizione a labbro
Lip gasket
Joint à lèvres
Junta de reborde
- 31. Corpo valvola manuale
Manual valve body
Corps vanne manuelle
Cuerpo válvula manual
- 32. Corpo manovra esterno
External operating body
Corps manoeuvre ext.
Cuerpo maniobra ext.
- 33. Rondella
Washer
Rondelle
Arandela
- 34. Maniglia
Handle
Poignée
Maneta
- 35. Grano
Dowel
Cheville
Pasador
- 36. Tappo
Plug
Bouchon
Tapón
- 37. Rondella
Washer
Rondelle
Arandela
- 38. Guarniz. doppio labbro
Two-lip gasket
Joint à deux lèvres
Junta de reborde doble
- 39. Pistone v. pn. 3 vie
Piston 3-way pn. v.
Piston v. pn. 3 voies
Pistón v. n. 3 vías
- 40. Pistone v. pn. 2 vie
Piston 2-way pn. v.
Piston v. 2 voies
Pistón v. n. 2 vías



CODIFICAZIONE
CODING
CODIFICATION
CODIFICACIÓN

Pos.	Cod. base	Norme	1" 25	D 25 28	D 32 34	1 1/2" 38	D 40 40	2" 51	D 50 52	2 1/2" 63	D 65 70	3" 76	D 80 85	4" 101	D 100 101	Mat.	Part. o agg.
1	800		25/40	25/40	25/40	25/40	25/40	51/52	51/52	63/76	63/76	63/76	85	101	101	4L	01
2	800		25/40	25/40	25/40	25/40	25/40	51/52	51/52	63/76	63/76	63/76	85	101	101	4L	02
3	800		25/40	25/40	25/40	25/40	25/40	51/52	51/52	63/76	63/76	63/76	85	101	101	4L	03
4	800		25/40	25/40	25/40	25/40	25/40	51/52	51/52	63/76	63/76	63/76	85	101	101	4L	04
5	800		25/40	25/40	25/40	25/40	25/40	51/52	51/52	63/76	63/76	63/76	85	101	101	N	05
6	800		25/40	25/40	25/40	25/40	25/40	51/52	51/52	63/76	63/76	63/76	85	101	101	4L	06
7	800		25/85	25/85	25/85	25/85	25/85	25/85	25/85	25/85	25/85	25/85	25/85	101	101	4L	07
8	800		25/52	25/52	25/52	25/52	25/52	25/52	25/52	63/76	63/76	63/76	85	101	101	4L	08
9	800		25/101	25/101	25/101	25/101	25/101	25/101	25/101	25/101	25/101	25/101	25/101	25/101	25/101	4L	09
10	800		25/101	25/101	25/101	25/101	25/101	25/101	25/101	25/101	25/101	25/101	25/101	25/101	25/101	4L	10
11	OR		108	108	108	108	108	108	108	108	108	108	108	108	108	N	
12	800		25/85	25/85	25/85	25/85	25/85	25/85	25/85	25/85	25/85	25/85	25/85	101	101	4L	12
13	800		25/85	25/85	25/85	25/85	25/85	25/85	25/85	25/85	25/85	25/85	25/85	101	101	4L	13
14	800		1/8"	1/8"	1/8"	1/8"	1/8"	1/8"	1/8"	1/8"	1/8"	1/8"	1/8"	1/8"	1/8"	OT	14
15	SEE		A18	A18	A18	A18	A18	A18	A18	A18	A18	A18	A18	A21	A21	AC	
16	SEE		J66	J66	J66	J66	J66	J82	J82	J100	J100	J100	J114	J145	J145	AC	
17	OR		123	123	123	123	123	123	123	123	123	123	123	3087	3087	N	
18	OR		108	108	108	108	108	108	108	108	108	108	108	2043	2043	N	
19	OR		3225	3225	3225	3225	3225	177	177	4362	4362	4362	4425	4537	4537	N	
20	800		25/52	25/52	25/52	25/52	25/52	25/52	25/52	63/76	63/76	63/76	4450	4575	4575	N	
21	014		1	1	1	1	1	1	1	1	1	1	1	1	1		
22	015		U	U	U	U	U	U	U	U	U	U	U	U	U		
23	800		25/40	25/40	25/40	25/40	25/40	51/52	51/52	63/76	63/76	63/76	85	101	101	AC	23
24	800		25/40	25/40	25/40	25/40	25/40	51/52	51/52	63/85	63/85	63/85	63/85	101	101	4L	24
25	800		25	28	34	38	40	51	52	63	70	76	85	101	101	4L	25
26	800		25	28	34	38	40	51	52	63	70	76	85	101	101	4L	26
27	800		25	28	34	38	40	51	52	63	70	76	85	101	101	4L	27
28	800		25	28	34	38	40	51	52	63	70	76	85	101	101	4L	28
29	800		25/40	25/40	25/40	25/40	25/40	51/52	51/52	63/85	63/85	63/85	63/85	101	101	N	29
30	800		25/28	25/28	34	38/40	38/40	51/52	51/52	63	70	76	85	101	101	E/S/T/V	30
31	850		25/40	25/40	25/40	25/40	25/40	51/52	51/52	63/85	63/85	63/85	63/85	101	101	4L	31
32	850		25/40	25/40	25/40	25/40	25/40	51/52	51/52	63/85	63/85	63/85	63/85	101	101	4L	32
33	850		25/101	25/101	25/101	25/101	25/101	25/101	25/101	25/101	25/101	25/101	25/101	25/101	25/101	AC	33
34	SE		25/40	25/40	25/40	25/40	25/40	51/52	51/52	63/85	63/85	63/85	63/85	101	101	4L	34
35	GRA		8x10	8x10	8x10	8x10	8x10	8x10	8x10	8x10	8x10	8x10	8x10	8x10	8x10	BA	
36	850		25/101	25/101	25/101	25/101	25/101	25/101	25/101	25/101	25/101	25/101	25/101	25/101	25/101	4	36
37	850		25/101	25/101	25/101	25/101	25/101	25/101	25/101	25/101	25/101	25/101	25/101	25/101	25/101	4	37
38	8G1		25/40	25/40	25/40	25/40	25/40	51/52	51/52	63/85	63/85	63/85	63/85	101	101	E/S	38
39	850		25	28	34	38	40	51	52	63	70	76	85	101	101	4L	39
40	850		25	28	34	38	40	51	52	63	70	76	85	101	101	4L	40

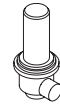

VALVOLE PNEUMATICHE NORME 3-A

- Realizzate seguendo rigorosamente i criteri e i test imposti dalle norme 3-A.
- Parti a contatto con il fluido costruite esclusivamente in acciaio inossidabile AISI 316L.
- Completo autodrenaggio della valvola garantito dalla forma sferica interna e dalla lucidatura delle parti interne.
- Elementi di tenuta facilmente raggiungibili durante le fasi di lavaggio CIP.
- Facilità di manutenzione consentita dall'assemblaggio della valvola mediante un morsetto Clamp a 3 ganasce.
- Entrata aria nella testata superiore della valvola e distribuzione nella parte inferiore tramite il pistone interno.
- Assoluta sicurezza durante le operazioni di montaggio e smontaggio garantita da un speciale dispositivo per il costante contenimento in compressione delle molle.
- Presenza di una speciale bussola a garanzia della perfetta coassialità del cilindro rispetto al corpo valvola, per la facilitazione dello scorrimento delle parti in movimento, la completa tenuta del prodotto e la totale igienicità durante le fasi di lavaggio CIP, consentite anche dalla presenza di un anello di tenuta OR nella parte finale.
- Facilmente sterilizzabili.
- Produzione standard: estremità Clamp o estremità a saldare. A richiesta, disponibili con estremità filettate norme DIN, SMS, RJT, ISS.
- Finitura standard: lucidatura esterna e satinatura interna grana 150 (finitura LS); a richiesta, lucidatura esterna e interna grana 240 (finitura LL), lucidatura elettrolitica grana 400 (finitura LE).
- Massima pressione di esercizio: 5 bar.

3-A PNEUMATIC VALVES

- Produced in strict conformity with criteria and tests required by 3-A standards.
- Parts in contact with the fluid made exclusively of AISI 316L stainless steel.
- Full self-drainage of valve due to spherical internal shape and polishing of internal parts.
- Seal members easy to access during CIP process.
- Easy maintenance due to assembly of valve using 3-piece clamp.
- Air entry into the upper head of the valve and distribution in the lower part by an internal piston.
- Absolute safety during assembly and disassembly, ensured by a special device to keep the springs under constant compression.
- Special bushing to ensure perfect coaxiality of cylinder and valve body, to facilitate moving parts, full product sealing and total hygiene during CIP process thanks also to the OR seal ring in terminal part.
- Easy to sterilize.
- Standard production: Clamp or welded ends. Available on request with threaded ends to DIN, SMS, RJT and ISS standards.
- Standard finish: 150 grain external polishing and internal glazing (LS finish); on request 240 grain external and internal polishing (LL finish), 400 grain electrolytic polishing (LE finish).
- Maximum operating pressure: 5 bars.

VANNES PNEUMATIQUES NORMES 3-A

- Réalisées en respectant scrupuleusement les critères et les tests imposés par les normes 3-A.
- Parties en contact avec le fluide fabriquées exclusivement en acier inoxydable AISI 316L.
- Autodrainage complet de la vanne garanti par la forme interne sphérique et le polissage des parties internes.
- Éléments d'étanchéité faciles à atteindre durant les opérations de lavage CIP.
- Entretien facile grâce à l'assemblage de la vanne avec un collier Clamp 3 pièces.
- Admission de l'air par la partie supérieure de la vanne et refoulement dans la partie inférieure à l'aide du piston interne.
- Sécurité absolue au cours des opérations de montage et démontage grâce à un dispositif spécial assurant le maintien constant sous compression des ressorts.
- Présence d'une douille spéciale garantissent la parfaite coaxialité du cylindre par rapport au corps de la vanne, facilitant le glissement des pièces en mouvement, assurant l'étanchéité totale du produit et une hygiène complète lors des opérations de lavage CIP. Ces propriétés sont rendues possibles aussi par la présence d'un joint torique dans la partie finale.
- Facilement stérilisables.

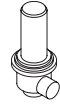

- Production standard: bouts Clamp ou bouts à souder. Sur demande, disponibles avec bouts filetés conformes aux normes DIN, SMS, RJT, ISS.
- Finissage standard: polissage extérieur et satinage intérieur grain 150 (finissage LS); sur demande, polissage extérieur et intérieur grain 240 (finissage LL), polissage électrolytique grain 400 (polissage LE).
- Pression d'exploitation maximum: 5 bars.

VÁLVULAS NEUMÁTICAS NORMAS 3-A

- Realizadas respetando rigurosamente los criterios y los tests establecidos por las normas 3-A.
- Las partes que están en contacto con el fluido se fabrican exclusivamente en acero inoxidable AISI 316L.
- Completo autodrenaje de la válvula garantizado por la forma interior esférica y por el pulido de las partes interiores.
- Elementos de cierre a los que se puede llegar fácilmente durante el proceso de lavado CIP.
- Facilidad de mantenimiento gracias al ensamblado de la válvula mediante una abrazadera de 3 mordazas.
- Entrada de aire por la parte superior de la válvula y distribución en la parte inferior mediante el pistón interno.
- Absoluta seguridad durante las operaciones de montaje y desmontaje, garantizada por un dispositivo especial que permite mantener constantemente bajo compresión los muelles.
- Presencia de un casquillo especial para garantizar la perfecta coaxialidad del cilindro con respecto al cuerpo de la válvula, para facilitar el desplazamiento de las partes en movimiento, el cierre perfecto del producto y la más completa higiene durante las fases de lavado CIP, gracias también a la presencia de una junta OR en la parte final.
- Fácilmente esterilizables.
- Producción estandar: extremos Clamp o extremos para soldar. A pedido, disponibles con extremos fileteados según normas DIN, SMS, RJT, ISS.
- Acabado estándar: pulido exterior y satinado interior grano 150 (acabado LS); a pedido, pulido exterior e interior grano 240 (acabado LL), pulido electrolítico grano 400 (acabado LE).
- Máxima presión de ejercicio: 5 bares.

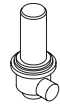

VALVOLA PNEUMATICA NORME 3-A
 3-A PNEUMATIC VALVE
 VANNE PNEUMATIQUE NORMES 3-A
 VÁLVULA NEUMÁTICA NORMAS 3-A

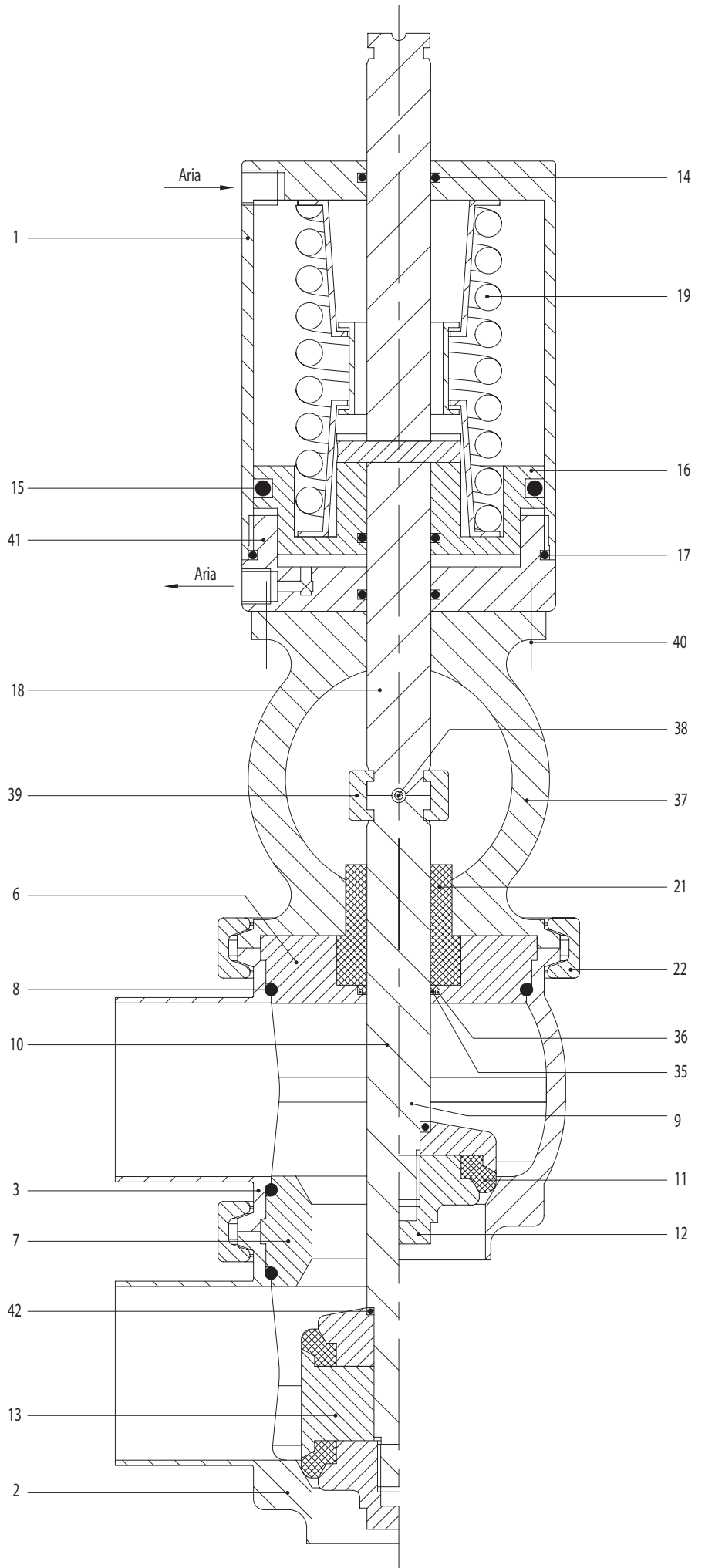
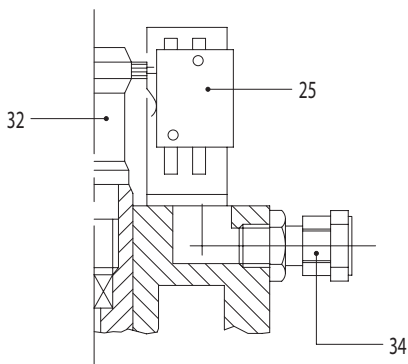
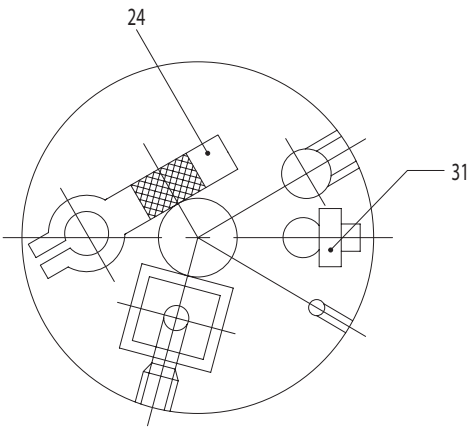
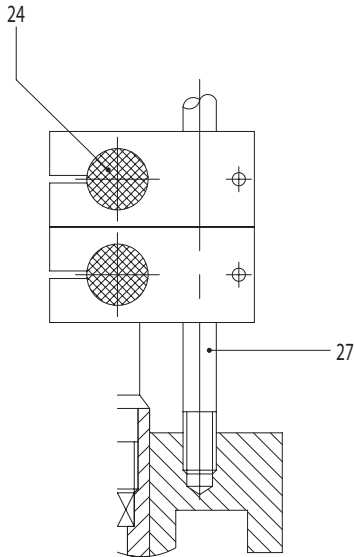

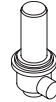

- | | | |
|--|--|---|
| 1. Cilindro
Cylinder
Cylindre
Cilindro | 14. Anello di tenuta OR
OR seal ring
Joint torique
Junta OR | 31. Morsetteria
Terminal strip
Bornier
Tablero de bornes |
| 2. Corpo valvola
Valve body
Corps vanne
Cuerpo válvula | 15. Anello di tenuta OR
OR seal ring
Joint torique
Junta OR | 32. Perno microinterruttore
Microswitch pin
Pivot minirupteur
Perno microrruptor |
| 3. Corpo intermedio
Middle body
Corps intermédiaire
Cuerpo intermedio | 16. Pistone
Piston
Piston
Pistón | 34. Pressacavo
Cable-grommet
Serre-câble
Sujeta cables |
| 6. Testata superiore
Top head
Tête supérieure
Cabezal superior | 17. Anello di tenuta OR
OR seal ring
Joint torique
Junta OR | 35. Rondella PTFE
PTFE washer
Rondelle PTFE
Arandela PTFE |
| 7. Testata inferiore
Bottom head
Tête inférieure
Cabezal inferior | 18. Albero
Shaft
Arbre
Eje | 36. Anello di tenuta OR
OR seal ring
Joint torique
Junta OR |
| 8. Anello di tenuta OR
OR seal ring
Joint torique
Junta OR | 19. Molla
Spring
Ressort
Muelle | 37. Lanterna
Lantern
Lanterne
Linterna |
| 9. Otturatore v. pn. 2 vie
Shutter 2-way pn. v.
Obturateur v. pn. 2 v.
Obturador v. neum. 2 v. | 21. Bussola PTFE
PTFE bush
Douille PTFE
Casquillo PTFE | 38. Vite
Screw
Vis
Tornillo |
| 10. Otturatore v. pn. 3 vie
Shutter 3-way pn. v.
Obturateur v. pn. 3 v.
Obturador v. neum. 3 v. | 22. Morsetto Clamp
Clamp
Collier Clamp
Abrazadera Clamp | 39. Anello di raccordo
Joining ring
Bague de raccord
Anillo de conexión |
| 11. Guarnizione a labbro
Lip gasket
Joint à lèvres
Junta de reborde | 24. Contatto di prossimità
Proximity contact
Contact de proximité
Microsensor | 40. Vite
Screw
Vis
Tornillo |
| 12. Ghiera di bloccaggio
Locking collar
Bague de blocage
Tuerca de seguridad | 25. Microinterruttore
Microswitch
Minirupteur
Microrruptor | 41. Tappo
Blank
Bouchon
Tapón |
| 13. Distanziale
Spacer
Entretoise
Distanciador | 27. Tirante
Tie rod
Tirant
Tirante | 42. Anello di tenuta OR
Or seal ring
Joint torique
Junta OR |

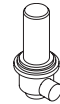

CODIFICAIONE
CODING
CODIFICATION
CODIFICACIÓN

Pos.	Cod. base	Norme	1" 25	DN 25 28	DN 32 34	1 1/2" 38	DN 40 40	2" 51	DN 50 52	2 1/2" 63	DN 65 70	3" 76	DN 80 85	Mat.	Part. o agg.
1	900		25/40	25/40	25/40	25/40	25/40	51/52	51/52	63/70	63/70	76/85	76/85	4L	01
2	900		25	28	34	38	40	51	52	63	70	76	85	6L	02
3	900		25	28	34	38	40	51	52	63	70	76	85	6L	03
6	900		25/40	25/40	25/40	25/40	25/40	51/52	51/52	63/70	63/70	76/85	76/85	6L	06
7	900		25/40	25/40	25/40	25/40	25/40	51/52	51/52	63	70	76	85	6L	07
8	OR		149	149	149	149	149	168	168	4300	4300	6337	6337	N	
9	9T2		25	28	34	38	40	51/52	51/52	63	70	76	85	6L	09
10	9T4		25	28	34	38	40	51/52	51/52	63	70	76	85	6L	10
11	900		25/28	25/28	34/40	34/40	34/40	51/52	51/52	63	70	76	85	T	11
12	900		25/28	25/28	34/40	34/40	34/40	51/52	51/52	63	70	76	85	6L	12
13	900		25	28	34	38	40	51/52	51/52	63	70	76	85	6L	13
14	OR		123	123	123	123	123	123	123	123	123	123	123	N	
15	OR		6237	6237	6237	6237	6237	6275	6275	185	185	6387	6387	N	
16	900		25/40	25/40	25/40	25/40	25/40	51/52	51/52	63/70	63/70	76/85	76/85	AL	16
17	OR		3268	3268	3268	3268	3268	3300	3300	3375	3375	3400	3400	N	
18	900		25/40	25/40	25/40	25/40	25/40	51/52	51/52	63/70	63/70	76/85	76/85	4CR	18
19	900		25/40	25/40	25/40	25/40	25/40	51/52	51/52	63/70	63/70	76/85	76/85	AC	19
21	900		25/85	25/85	25/85	25/85	25/85	25/85	25/85	25/85	25/85	25/85	25/85	T	21
22	K13		51	51	51	51	51	76	76	89	89	101	101	4L	22
24	013		S	S	S	S	S	S	S	S	S	S	S		
25	014		1	1	1	1	1	1	1	1	1	1	1		
27	900		25/101	25/101	25/101	25/101	25/101	25/101	25/101	25/101	25/101	25/101	25/101	4L	27
31	900		25/101	25/101	25/101	25/101	25/101	25/101	25/101	25/101	25/101	25/101	25/101	4	31
32	900		25/101	25/101	25/101	25/101	25/101	25/101	25/101	25/101	25/101	25/101	25/101	4	32
34	010 1		PG7	PG7	PG7	PG7	PG7	PG7	PG7	PG7	PG7	PG7	PG7		
35	900		25/85	25/85	25/85	25/85	25/85	25/85	25/85	25/85	25/85	25/85	25/85	T	35
36	OR		3075	3075	3075	3075	3075	3075	3075	3075	3075	3075	3075	N	
37	900		25/40	25/40	25/40	25/40	25/40	51/52	51/52	63/70	63/70	76/85	76/85	4L	37
38	TSVCE		4x28	4x28	4x28	4x28	4x28	4x28	4x28	4x28	4x28	4x28	4x28	4L	
39	900		25/85	25/85	25/85	25/85	25/85	25/85	25/85	25/85	25/85	25/85	25/85	4L	39
40	TE		6x16	6x16	6x16	6x16	6x16	6x16	6x16	6x16	6x16	6x16	6x16	4L	
41	900		25/40	25/40	25/40	25/40	25/40	51/52	51/52	63/70	63/70	76/85	76/85	4L	41
42	OR		2043	2043	2043	2043	2043	2043	2043	2043	2043	2043	2043	N	

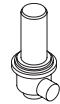

**GUARNIZIONI
GASKETS**

**JOINTS
JUNTAS**

GUARNIZIONE A DOPPIO LABBRO
TWO-LIP GASKET
JOINT À DEUX LÈVRES
JUNTA DE REBORDE DOBLE

GUARNIZIONE METALLICA CON OR
METALLIC GASKET WITH OR
JOINT MÉTALLIQUE AVEC OR
JUNTA METÁLICA CON OR

GUARNIZIONE METALLICA PER
STERILIZZAZIONE A VAPORE
METALLIC GASKET FOR STEAM
STERILIZATION
JOINT MÉTALLIQUE POUR
STÉRILISATION À VAPEUR
JUNTA METÁLICA PARA
ESTERILIZACIÓN CON VAPOR

GUARNIZIONE METALLICA CON
COMPENSAZIONE DI USURA
METALLIC GASKET WITH WEAR
COMPENSATION
JOINT MÉTALLIQUE AVEC
COMPENSATION D'USURE
JUNTA METÁLICA CON
COMPENSACIÓN DE DESGASTE

8G1



8G2

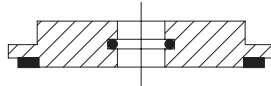

8G3

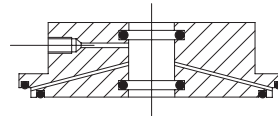

8G4

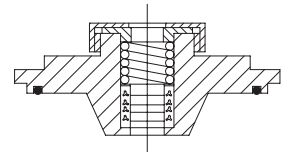

**OTTURATORI
SHUTTERS**

**OBTURATEURS
OBTURADORES**

OTTURATORE V. PN. 2 VIE
SHUTTER 2-WAY PN. V.
OBTURATEUR V. PN. 2 VOIES
OBTURADOR V. N. 2 VÍAS

OTTURATORE V. PN. 3 VIE
SHUTTER 3-WAY PN. V.
OBTURATEUR V. PN. 3 VOIES
OBTURADOR V. N. 3 VÍAS

OTTURATORE CON GUARN. A SOFFIETTO
SHUTTER WITH BELLOWS GASKET
OBTURATEUR AVEC JOINT À SOUFFLET
OBTURADOR CON JUNTA DE FUELLE

8T2

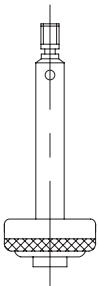

8T4

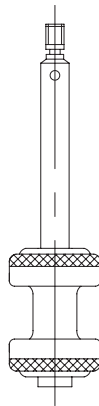

8G5

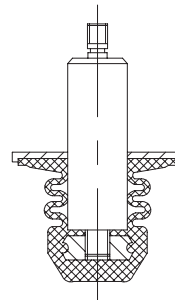

OTTURATORE V. PN. 3-A 2 VIE
SHUTTER 3-A PN. V. 2-WAY
OBTURATEUR V. PN. 3-A 2 VOIES
OBTURADOR V. N. 3-A 2 VÍAS

OTTURATORE V. PN. 3-A 3 VIE
SHUTTER 3-A PN. V. 3-WAY
OBTURATEUR V. PN. 3-A 3 VOIES
OBTURADOR V. N. 3-A 3 VÍAS

9T2

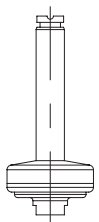

9T4

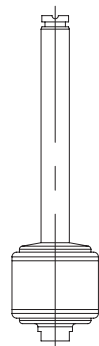

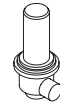

COMPONENTI ELETTRICI
ELECTRICAL PARTS

PIÈCES ÉLECTRIQUES
PIEZAS ELÉCTRICAS

ELETTROVALVOLA NA.
SOLENOID VALVE NO.
ÉLECTROVANNE NO.
ELECTROVÁLVULA NA.

ELETTROVALVOLA NC.
SOLENOID VALVE NC.
ÉLECTROVANNE NF.
ELECTROVÁLVULA NC.

CONTATTO DI PROSSIMITÀ
PROXIMITY CONTACT
CONTACT DE PROXIMITÉ
MICROSENSOR

CONTATTO DI PROSSIMITÀ
PROXIMITY CONTACT
CONTACT DE PROXIMITÉ
MICROSENSOR

015 NA

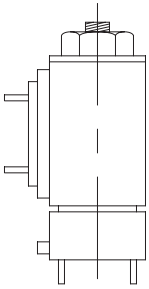

015 NC

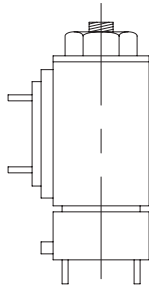

**013 A
013 A/N
013 A/N/EX**

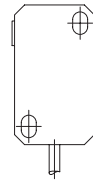

013 S

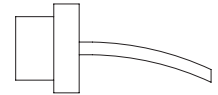

MICROINTERRUTTORE
MICROSWITCH
MINIRUPTEUR
MICRORRUPTOR

MICROINTERRUTTORE PNEUMATICO
PNEUMATIC MICROSWITCH
MINIRUPTEUR PNEUMATIQUE
MICRORRUPTOR NEUMÁTICO

CONNETTORE
CONNECTOR
CONNECTEUR
CONECTOR

CONNETTORE
CONNECTOR
CONNECTEUR
CONECTOR

014 1

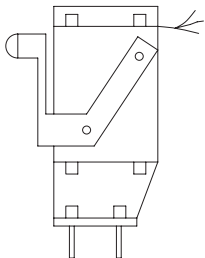

014 2

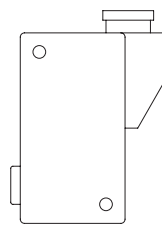

030 H

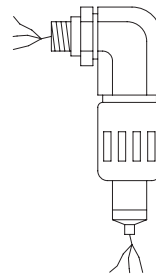

030 S

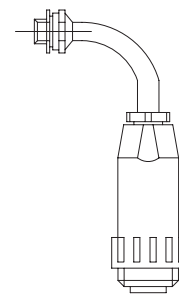

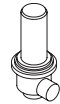

COMBINAZIONI
BODY COMBINATIONS
COMBINAISONS
COMBINACIONES

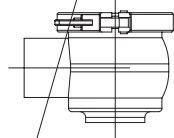

L

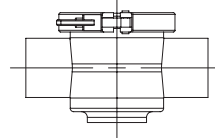

T

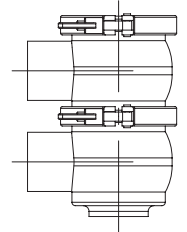

LL

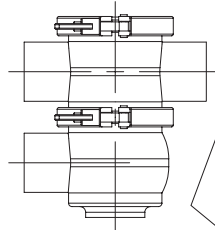

TL

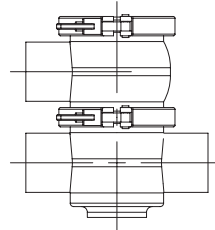

LT

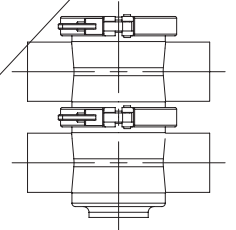

TT

DIAGRAMMI DI FLUSSO
FLOWCHARTS
DIAGRAMMES DE FLUX
DIAGRAMAS DE FLUJO

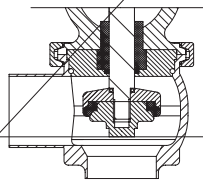

L

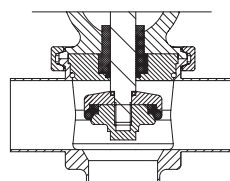
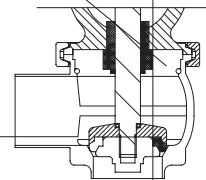

T

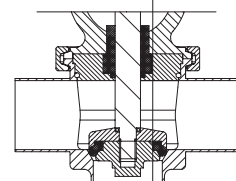

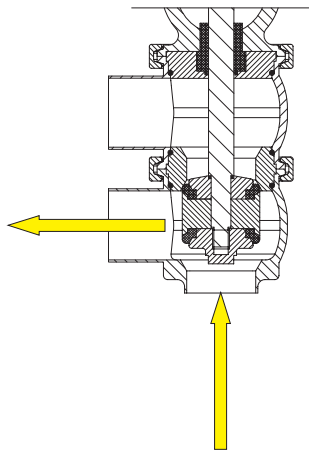
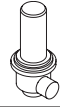

LL

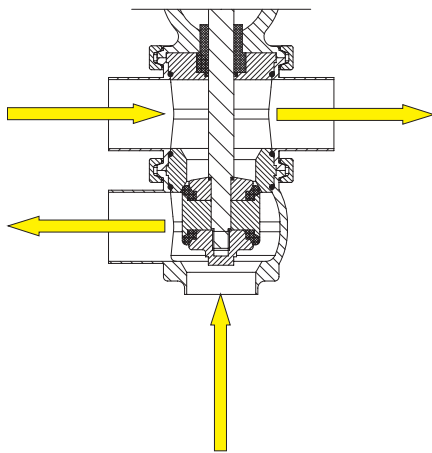
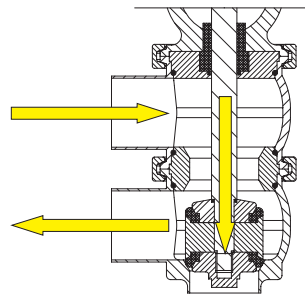

TL

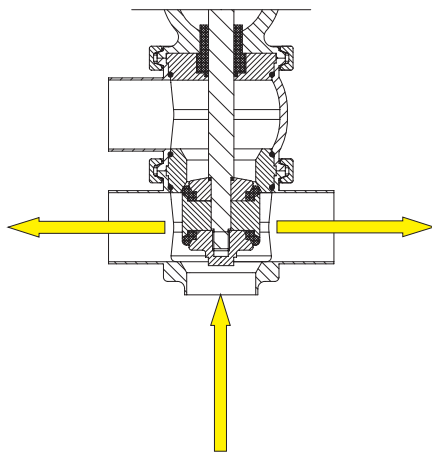
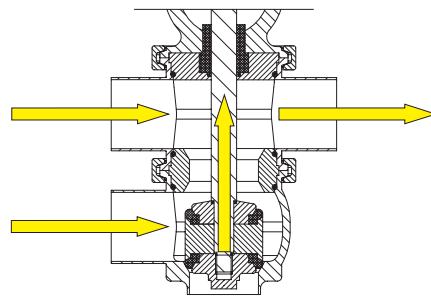

LT

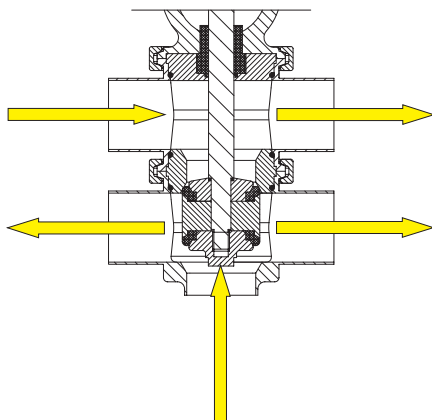
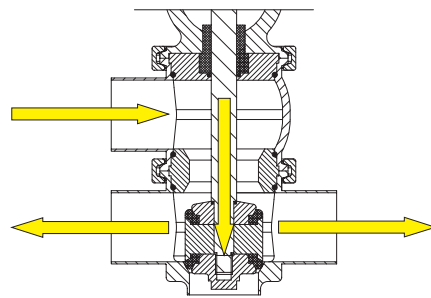

TT

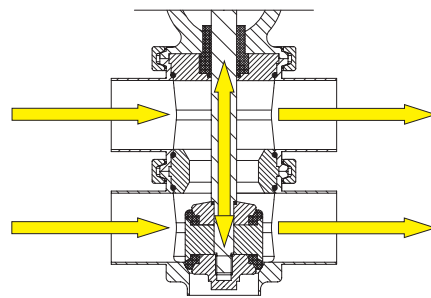

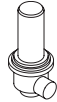

PERDITE DI CARICO

PERTES DE CHARGE

PRESSURE DROP

PÉRDIDA DE CARGA

VALVOLA PNEUMATICA 2 VIE L
PNEUMATIC VALVE 2-WAY L

VANNE PNEUMATIQUE 2 VOIES L
VÁLVULA NEUMÁTICA 2 VÍAS L

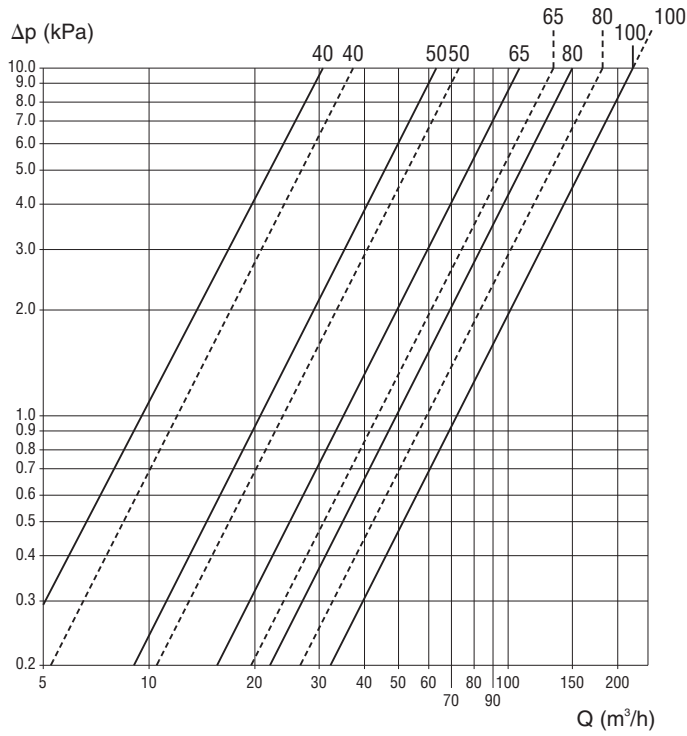

VALVOLA PNEUMATICA 3 VIE LL
PNEUMATIC VALVE 3-WAY LL

VANNE PNEUMATIQUE 3 VOIES LL
VÁLVULA NEUMÁTICA 3 VÍAS LL

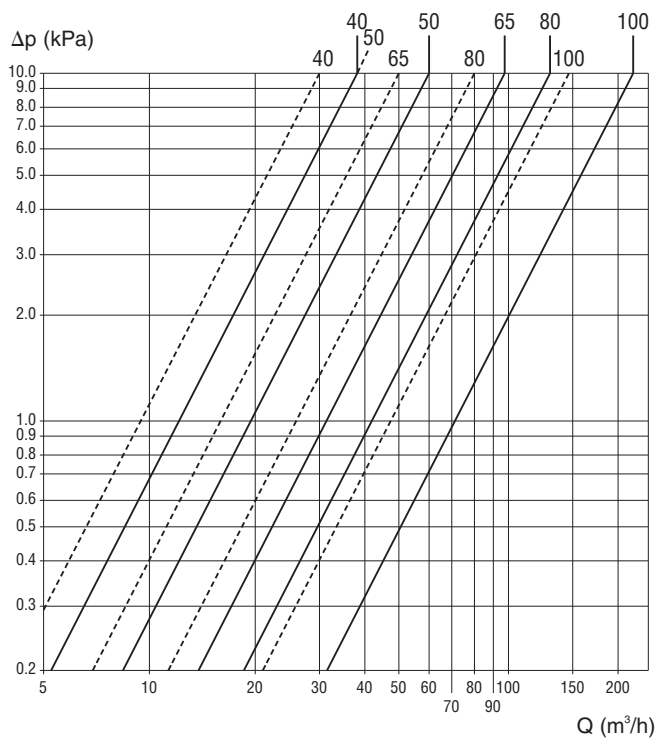

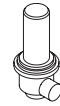

VALVOLE PNEUMATICHE DI DRENAGGIO

- Parti a contatto con il fluido costruite esclusivamente in acciaio inossidabile AISI 316L.
- Entrata aria nella testata superiore della valvola e distribuzione nella parte inferiore tramite il pistone interno.
- Assoluta sicurezza durante le operazioni di montaggio e smontaggio garantita da uno speciale dispositivo per il costante contenimento in compressione delle molle.
- Nessuna possibilità di contatto tra prodotto e liquido di lavaggio CIP.
- Progettazione sanitaria che garantisce un completo autodrenaggio di tutte le parti interne durante le fasi di lavaggio CIP.
- Tamponi di chiusura bilanciati per evitare eventuali colpi di ariete durante le fasi di lavorazione.
- Perfetta tenuta durante le fasi di lavaggio CIP assicurata da speciali guarnizioni.
- Finitura standard: lucidatura esterna e satinatura interna grana 120. Altre finiture a richiesta.
- Max. pressione di esercizio: 5 bar.

DRAINAGE PNEUMATIC VALVES

- Parts in contact with the fluid made exclusively of AISI 316L stainless steel.
- Air entry into the upper head of the valve and distribution in the lower part by an internal piston.
- Absolute safety during assembly and disassembly, ensured by a special device to keep the springs under constant compression.
- No chance of contact between the product and the CIP washing liquid.
- Sanitary design ensuring complete self-drainage of all internal parts during CIP washing phases.
- Balanced closing plugs to prevent ram effect during processing steps.
- Perfect seal during CIP washing, ensured by special gaskets.
- Standard finish: 120 grain external polishing and internal glazing. Other finishes on request.
- Maximum operating: pressure 5 bars.

VANNES PNEUMATIQUES DE DRAINAGE

- Parties en contact avec le fluide fabriquées exclusivement en acier inoxydable AISI 316L.
- Admission de l'air par la partie supérieure de la vanne et refoulement dans la partie inférieure à l'aide du piston interne.
- Sécurité absolue au cours des opérations de montage et démontage, grâce à un dispositif spécial assurant le maintien constant sous compression des ressorts.
- Aucune possibilité de contact entre le produit et le liquide de lavage CIP.
- Conception sanitaire garantissant un drainage automatique complet de toutes les parties intérieures pendant les phases de lavage CIP.
- Tampons de fermeture équilibrés pour éviter les éventuels coups de bélier pendant les phases d'usinage.
- Étanchéité parfaite pendant les phases de lavage CIP, assurée par des joints spéciaux.
- Finissage standard: polissage extérieur et satinage intérieur grain 120. Autres finissages sur demande.
- Pression de service maximale: 5 bars.

VÁLVULAS NEUMÁTICAS DE DRENAJE

- Las partes que están en contacto con el fluido son fabricadas exclusivamente en acero inoxidable AISI 316L.
- Entrada de aire por la parte superior de la válvula y distribución en la parte inferior mediante el pistón interno.
- Absoluta seguridad durante las operaciones de montaje y desmontaje, garantizada por un dispositivo especial que permite mantener constantemente bajo compresión los muelles.
- Ninguna posibilidad de contacto entre el producto y el líquido de lavado CIP.
- Proyecto sanitario que garantiza un completo autodrenaje de todas las partes internas durante las fases de lavado CIP.
- Tapones de cierre balanceados para evitar posibles golpes de ariete durante las fases de trabajo.
- Cierre hermético durante las fases de lavado CIP, asegurado por juntas especiales.
- Acabado estándar: pulido exterior y satinado interior grano 120. A pedido, se pueden suministrar otros acabados.
- Máxima presión de ejercicio: 5 bares.

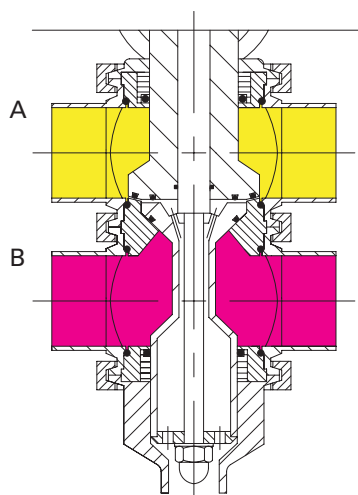

Posizione di lavoro.
Il prodotto di lavaggio (A) non può mescolarsi con il fluido (B). Eventuali perdite fuoriescono dalla valvola senza alcuna possibilità di contatto tra prodotto e liquido di lavaggio CIP.

Working position.
The washing product (A) cannot mix with the fluid (B). Any leaks run out of the valve with no chance of contact between the product and the CIP liquid.

Position de travail. Le produit de lavage (A) ne peut se mélanger avec le liquide (B). Les éventuelles fuites sortent de la vanne sans aucune possibilité de contact entre le produit et le liquide de lavage CIP.

Posición de trabajo. El producto de lavado (A) no se puede mezclar con el fluido (B). Eventualmente se pueden verificar pérdidas de la válvula sin que exista la posibilidad de que el producto y el líquido de lavado CIP entren en contacto.

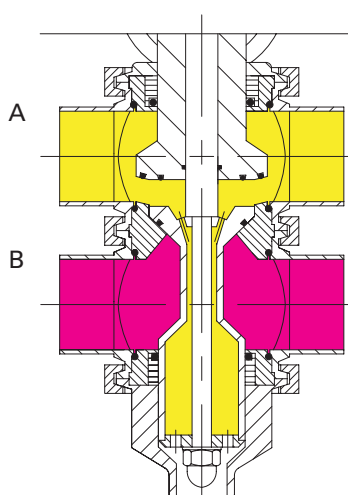

Posizione di lavoro e contemporaneo lavaggio della guarnizione del tampone di chiusura superiore. Eventuali perdite fuoriescono dalla valvola senza alcuna possibilità di contatto tra prodotto e liquido di lavaggio CIP.

Working and simultaneous washing position for the upper closing plug gasket. Any leaks run out of the valve with no chance of contact between the product and the CIP liquid.

Position de travail et lavage simultané du joint du tampon de fermeture supérieur. Les éventuelles fuites sortent de la vanne sans aucune possibilité de contact entre le produit et le liquide de lavage CIP.

Posición de trabajo y lavado simultáneo de la junta del tapón de cierre superior. Eventualmente se pueden verificar pérdidas de la válvula sin que exista la posibilidad de que el producto y el líquido de lavado CIP entren en contacto.

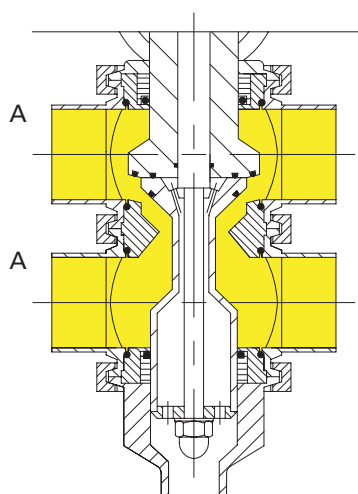

Posizione di lavaggio totale.

Complete washing position.

Position de lavage complète.

Posición de lavado completo.

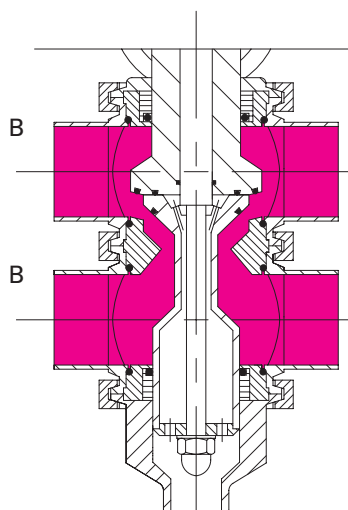

Posizione di lavoro totale.

Complete working position.

Position de travail complète.

Posición de trabajo completo.

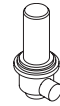

VALVOLA PNEUMATICA DI DRENAGGIO
 DRAINAGE PNEUMATIC VALVE
 VANNE PNEUMATIQUE DE DRAINAGE
 VÁLVULA NEUMÁTICA DE DRENAJE

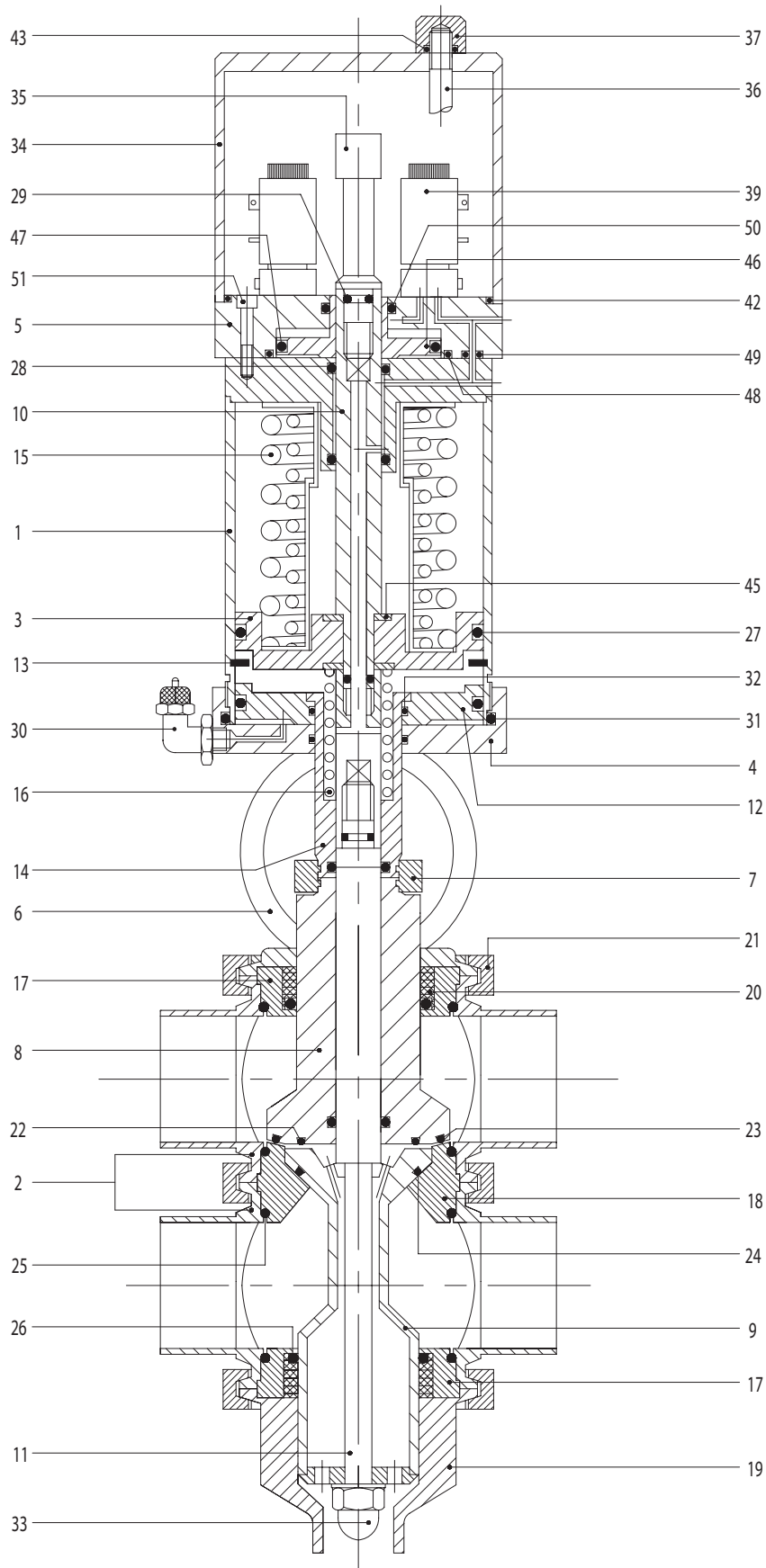

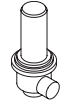

- | | | |
|---|--|---|
| 1. Cilindro
Cylinder
Cylindre
Cilindro | 17. Testata
Head
Tête
Cabezal | 33. Dado
Nut
Écrou
Tuerca |
| 2. Corpo valvola
Valve body
Corps vanne
Cuerpo válvula | 18. Testata intermedia
Middle head
Tête intermédiaire
Cabezal intermedio | 34. Cappello
Cap
Capot étanche
Capuchón |
| 3. Pistone
Piston
Piston
Pistón | 19. Corpo di protezione
Guard body
Corps de protection
Cuerpo de protección | 35. Perno contatto prossimità
Proximity contact pin
Came contact de proximité
Perno del microsensore |
| 4. Base
Cover
Base
Base | 20. Bussola PTFE
PTFE bush
Douille PTFE
Camisa PTFE | 36. Tirante
Tie rod
Tirant
Tirante |
| 5. Base unità di controllo
Control unit cover
Base unité de contrôle
Base unidad de control | 21. Morsetto Clamp
Clamp
Collier Clamp
Abrazadera Clamp | 37. Dado per cappello
Cap nut
Écrou pour capot
Tuerca para capuchón |
| 6. Lanterna
Lantern
Lanterne
Linterna | 22. Anello di tenuta OR
OR seal ring
Joint torique
Junta OR | 39. Elettrovalvola
Solenoid valve
Électrovanne
Electroválvula |
| 7. Elem. di accoppiamento
Coupling member
Élément d'assemblage
Elemento de acoplamiento | 23. Anello di tenuta OR
OR seal ring
Joint torique
Junta OR | 42. Anello di tenuta OR
OR seal ring
Joint torique
Junta OR |
| 8. Tampone di chiusura
Closing plug
Tampon de fermeture
Tapón de cierre | 24. Anello di tenuta OR
OR seal ring
Joint torique
Junta OR | 43. Anello di tenuta OR
OR seal ring
Joint torique
Junta OR |
| 9. Tamp. chiusura e scarico
Closing and drain plug
T. fermeture et décharge
Tapón de cierre y descarga | 25. Anello di tenuta OR
OR seal ring
Joint torique
Junta OR | 45. Rondella
Washer
Rondelle
Arandela |
| 10. Albero pistone
Piston rod
Arbre piston
Eje pistón | 26. Anello di tenuta OR
OR seal ring
Joint torique
Junta OR | 46. Pistone superiore
Upper piston
Piston supérieur
Pistón superior |
| 11. Albero tampone
Head seal
Arbre tampon
Eje tapón | 27. Anello di tenuta OR
OR seal ring
Joint torique
Junta OR | 47. Anello di tenuta OR
OR seal ring
Joint torique
Junta OR |
| 12. Pistone di drenaggio
Drainage piston
Piston de drainage
Pistón drenaje | 28. Anello di tenuta OR
OR seal ring
Joint torique
Junta OR | 48. Anello di tenuta OR
OR seal ring
Joint torique
Junta OR |
| 13. Seeger
Snap ring
Circlips
Anillo seeger | 29. Anello di tenuta OR
OR seal ring
Joint torique
Junta OR | 49. Anello di tenuta OR
OR seal ring
Joint torique
Junta OR |
| 14. Portamolla
Spring holder
Porte-ressort
Portamuelle | 30. Attacco aria
Air coupling
Prise air
Entrada aire | 50. Anello di tenuta OR
OR seal ring
Joint torique
Junta OR |
| 15. Molla
Spring
Ressort
Muelle | 31. Anello di tenuta OR
OR seal ring
Joint torique
Junta OR | 51. Vite
Screw
Vis
Tornillo |
| 16. Molla corsa parziale
Partial travel spring
Ressort course partielle
Muelle carrera parcial | 32. Anello di tenuta OR
OR seal ring
Joint torique
Junta OR | |



VALVOLE PNEUMATICHE DI DRENAGGIO
DRAINAGE PNEUMATIC VALVES
VANNES PNEUMATIQUES DE DRAINAGE
VÁLVULAS NEUMÁTICAS DE DRENAJE

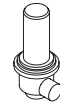

CODIFICAIONE
CODING
CODIFICATION
CODIFICACIÓN

Pos.	Cod. base	Norme	2" 51	2 1/2" 63	3" 76	Mat.	Part. o agg.
1	830		51	63/76	63/76	4L	01
2	836		51	63	76	6L	02
3	830		51	63/76	63/76	AC	03
4	830		51	63/76	63/76	4L	04
5	830		51	63/76	63/76	4L	05
6	830		51	63/76	63/76	4L	06
7	830		51	63/76	63/76	4L	07
8	830		51	63	76	6L	08
9	830		51	63	76	6L	09
10	830		51	63/76	63/76	6L	10
11	830		51	63	76	6L	11
12	830		51	63/76	63/76	AC	12
13	SEE		J 100	J 108	J 108	AC	
14	830		51	63/76	63/76	4L	14
15	830		51	63/76	63/76	4L	15
16	830		51	63/76	63/76	4L	16
17	830		51	63/76	63/76	6L	17
18	830		51	63/76	63/76	6L	18
19	830		51	63/76	63/76	4L	19
20	830		51	63/76	63/76	T	20
21	K 13		76	101	101	4L	
22	OR		4143	159	159	N	
23	OR		6200	6275	6275	N	
24	OR		147	6237	6237	N	
25	OR		168	6337	6337	N	
26	OR		6187	6212	6212	N	
27	OR		185	6387	6387	N	
28	OR		123	123	123	N	
29	OR		108	108	108	N	
30	800		1/8"	1/8"	1/8"	OT	30
31	OR		4412	4437	4437	N	
32	OR		3137	3137	3137	N	
33	830		34/76	34/76	34/76	4L	33
34	830		51	63/76	63/76	4L	34
35	830		34/76	34/76	34/76	4L	35
36	830		34/76	34/76	34/76	4L	36
37	830		34/76	34/76	34/76	4L	37
39	015		U	U	U		
42	OR		2540	2450	2450	N	
43	OR		108	108	108	N	
45	830		34/76	34/76	34/76	4L	45
46	830		51/76	51/76	51/76	4L	46
47	OR		6275	6275	6275	N	
48	OR		2325	2325	2325	N	
49	OR		2010	2010	2010	N	
50	OR		3100	3100	3100	N	
51	TCC		6x25	6x25	6x25	4L	

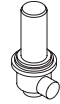

V. PNEUMATICA 2 V. L EL.
PNEUMATIC V. 2 W. L PE.
V. PNEUMATIQUE 2 V. L BL.
V. NEUMÁTICA 2 V. L EL.

800 L

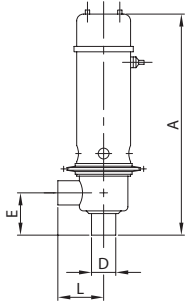

DN	A	D	E	L	gr
28	368,0	28,0	44,5	66,5	4.370
34	376,0	34,0	53,0	66,5	4.350
40	372,0	40,0	49,0	66,5	4.360
52	377,0	52,0	58,0	74,0	5.410
70	428,0	70,0	71,0	95,0	9.100
85	452,0	85,0	83,0	95,0	15.500
101	543,0	101,6	98,0	135,0	19.850
104	543,0	104,0	98,0	135,0	19.850

V. PNEUMATICA 3 V. T EL.
PNEUMATIC V. 3 W. T PE.
V. PNEUMATIQUE 3 V. T BL.
V. NEUMÁTICA 3 V. T EL.

805 L

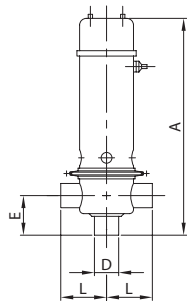

DN	A	D	E	L	gr
28	368,0	28,0	44,5	66,5	4.400
34	376,0	34,0	53,0	66,5	4.380
40	372,0	40,0	49,0	66,5	4.410
52	377,0	52,0	58,0	74,0	5.450
70	428,0	70,0	71,0	95,0	9.450
85	452,0	85,0	83,0	95,0	15.670
101	543,0	101,6	98,0	135,0	19.980
104	543,0	104,0	98,0	135,0	19.980

V. PNEUMATICA 3 V. LL EL.
PNEUMATIC V. 3 W. LL PE.
V. PNEUMATIQUE 3 V. LL BL.
V. NEUMÁTICA 3 V. LL EL.

810 L

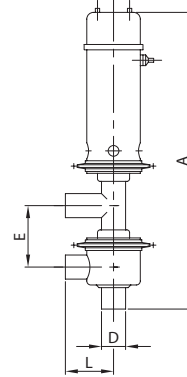

DN	A	D	E	L	gr
28	449,0	28,0	81,0	66,5	5.085
34	457,0	34,0	81,0	66,5	5.090
40	453,0	40,0	81,0	66,5	5.120
52	472,0	52,0	95,0	74,0	6.460
70	543,0	70,0	115,0	95,0	11.700
85	583,0	85,0	131,0	95,0	18.220
101	700,0	101,6	157,0	135,0	24.280
104	700,0	104,0	157,0	135,0	24.280

V. PNEUMATICA 4 V. LT EL.
PNEUMATIC V. 4 W. LT PE.
V. PNEUMATIQUE 4 V. LT BL.
V. NEUMÁTICA 4 V. LT EL.

815 L

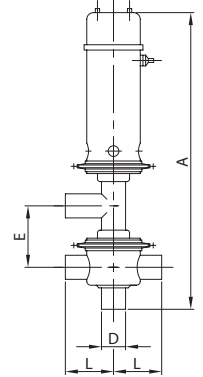

DN	A	D	E	L	gr
28	449,0	28,0	81,0	66,5	5.085
34	457,0	34,0	81,0	66,5	5.090
40	453,0	40,0	81,0	66,5	5.120
52	472,0	52,0	95,0	74,0	6.460
70	543,0	70,0	115,0	95,0	11.700
85	583,0	85,0	131,0	95,0	18.220
101	700,0	101,6	157,0	135,0	24.280
104	700,0	104,0	157,0	135,0	24.280

V. PNEUMATICA 2 V. L EF.
PNEUMATIC V. 2 W. L ME.
V. PNEUMATIQUE 2 V. L BF.
V. NEUMÁTICA 2 V. L ER.

801 D

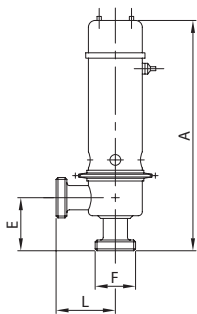

DN	A	E	F	L	gr
25	382,0	59,0	52-6	81,0	4.630
32	390,0	67,0	58-6	81,0	6.690
40	385,0	62,0	65-6	80,0	4.780
50	390,0	71,0	78-6	87,0	5.970
65	443,0	86,0	95-6	110,0	9.860
80	469,0	100,0	110-4	112,0	16.700
100	560,0	115,0	130-4	152,0	21.850
104	560,0	115,0	130-4	152,0	21.850

V. PNEUMATICA 3 V. T EF.
PNEUMATIC V. 3 W. T ME.
V. PNEUMATIQUE 3 V. T BF.
V. NEUMÁTICA 3 V. T ER.

806 D

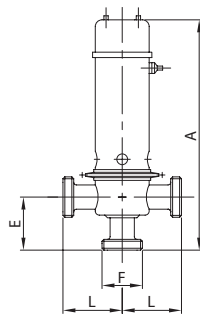

DN	A	E	F	L	gr
25	382,0	59,0	52-6	81,0	4.760
32	390,0	67,0	58-6	81,0	4.890
40	385,0	62,0	65-6	80,0	5.040
50	390,0	71,0	78-6	87,0	6.290
65	443,0	86,0	95-6	110,0	10.590
80	469,0	100,0	110-4	112,0	17.470
100	560,0	115,0	130-4	152,0	22.980
104	560,0	115,0	130-4	152,0	22.980

V. PNEUMATICA 3 V. LL EF.
PNEUMATIC V. 3 W. LL ME.
V. PNEUMATIQUE 3 V. LL BF.
V. NEUMÁTICA 3 V. LL ER.

811 D

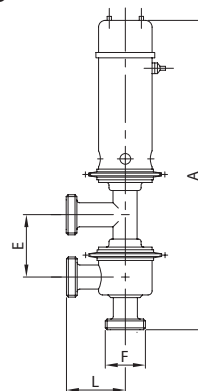

DN	A	E	F	L	gr
25	463,0	81,0	52-6	81,0	5.475
32	471,0	81,0	58-6	81,0	5.600
40	466,0	81,0	65-6	80,0	5.750
50	485,0	95,0	78-6	87,0	7.300
65	558,0	115,0	95-6	110,0	12.840
80	600,0	131,0	110-4	112,0	20.000
100	717,0	157,0	130-4	152,0	27.200
104	717,0	157,0	130-4	152,0	27.200

V. PNEUMATICA 4 V. LT EF.
PNEUMATIC V. 4 W. LT ME.
V. PNEUMATIQUE 4 V. LT BF.
V. NEUMÁTICA 4 V. LT ER.

816 D

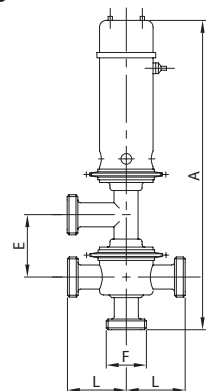

DN	A	E	F	L	gr
25	463,0	81,0	52-6	81,0	5.475
32	471,0	81,0	58-6	81,0	5.600
40	466,0	81,0	65-6	80,0	5.750
50	485,0	95,0	78-6	87,0	7.300
65	558,0	115,0	95-6	110,0	12.840
80	600,0	131,0	110-4	112,0	20.000
100	717,0	157,0	130-4	152,0	27.200
104	717,0	157,0	130-4	152,0	27.200

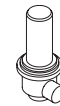

V. PNEUMATICA 4 V. TL EL.
PNEUMATIC V. 4 W. TL PE.
V. PNEUMATIQUE 4 V. TL BL.
V. NEUMÁTICA 4 V. TL EL.

820 L

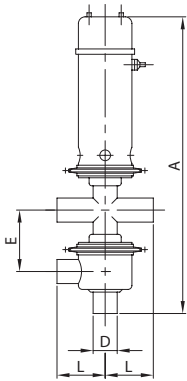

DN	A	D	E	L	gr
28	449,0	28,0	81,0	66,5	5.150
34	457,0	34,0	81,0	66,5	5.160
40	453,0	40,0	81,0	66,5	5.200
52	472,0	52,0	95,0	74,5	6.510
70	543,0	70,0	115,0	95,0	11.900
85	583,0	85,0	131,0	95,0	18.500
101	700,0	101,6	157,0	135,0	24.450
104	700,0	104,0	157,0	135,0	24.450

V. PNEUMATICA 5 V. TT EL.
PNEUMATIC V. 5 W. TT PE.
V. PNEUMATIQUE 5 V. TT BL.
V. NEUMÁTICA 5 V. TT BL.

825 L

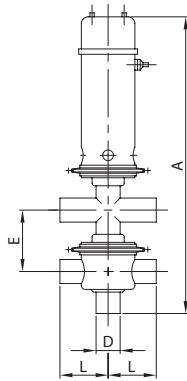

DN	A	D	E	L	gr
28	449,0	28,0	81,0	66,5	5.150
34	457,0	34,0	81,0	66,5	5.160
40	453,0	40,0	81,0	66,5	5.200
52	472,0	52,0	95,0	74,5	6.510
70	543,0	70,0	115,0	95,0	11.900
85	583,0	85,0	131,0	95,0	18.500
101	700,0	101,6	157,0	135,0	24.450
104	700,0	104,0	157,0	135,0	24.450

V. PNEUM. 3-A 2 V. L EL.
PNEUM. V. 3-A 2 W. L PE.
V. PNEUM. 3-A 2 V. L BL.
V. NEUM. 3-A 2 V. L EL.

900 L

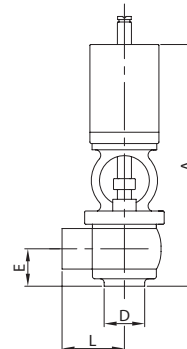

DN	A	D	E	L	gr
28	243,0	28,0	38,0	45,0	3.510
34	252,0	34,0	44,0	50,0	3.720
40	256,0	40,0	45,0	56,0	3.720
52	315,0	52,0	53,0	70,0	6.500
70	334,0	70,0	59,5	78,0	8.300
85	372,0	85,0	66,0	93,0	13.660
101	453,0	101,6	90,5	135,0	19.200

V. PNEUM. 3-A 3 V. T EL.
PNEUM. V. 3-A 3 W. T PE.
V. PNEUM. 3-A 3 V. T BL.
V. NEUM. 3-A 3 V. T EL.

905 L

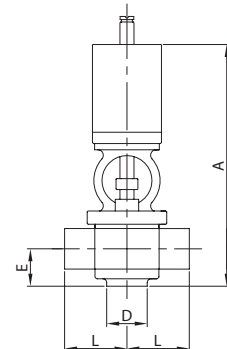

DN	A	D	E	L	gr
28	243,0	28,0	38,0	45,0	3.510
34	252,0	34,0	44,0	50,0	3.720
40	256,0	40,0	45,0	56,0	3.720
52	315,0	52,0	53,0	70,0	6.500
70	334,0	70,0	59,5	78,0	8.300
85	372,0	85,0	66,0	93,0	13.660
101	453,0	101,6	90,5	135,0	19.200

V. PNEUMATICA 4 V. TL EF.
PNEUMATIC V. 4 W. TL ME.
V. PNEUMATIQUE 4 V. TL BF.
V. NEUMÁTICA 4 V. TL ER.

821 D

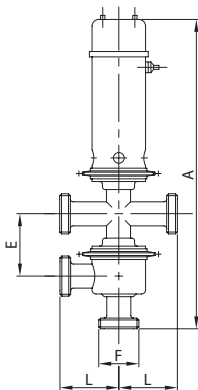

DN	A	E	F	L	gr
25	463,0	81,0	52-6	81,0	5.670
32	471,0	81,0	58-6	81,0	5.840
40	466,0	81,0	65-6	80,0	6.040
50	485,0	95,0	78-6	87,0	7.630
65	558,0	115,0	95-6	110,0	13.420
80	600,0	131,0	110-4	112,0	20.900
100	717,0	157,0	130-4	152,0	28.450
104	717,0	157,0	130-4	152,0	28.450

V. PNEUMATICA 5 V. TT EF.
PNEUMATIC V. 5 W. TT ME.
V. PNEUMATIQUE 5 V. TT BF.
V. NEUMÁTICA 5 V. TT ER.

826 D

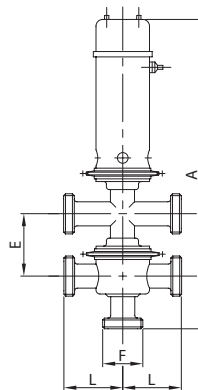

DN	A	E	F	L	gr
25	463,0	81,0	52-6	81,0	5.670
32	471,0	81,0	58-6	81,0	5.840
40	466,0	81,0	65-6	80,0	6.040
50	485,0	95,0	78-6	87,0	7.630
65	558,0	115,0	95-6	110,0	13.420
80	600,0	131,0	110-4	112,0	20.900
100	717,0	157,0	130-4	152,0	28.450
104	717,0	157,0	130-4	152,0	28.450

V. PNEUM. 3-A 2 V. L EF.
PNEUM. V. 3-A 2 W. L ME.
V. PNEUM. 3-A 2 V. L BF.
V. NEUM. 3-A 2 V. L ER.

901 D

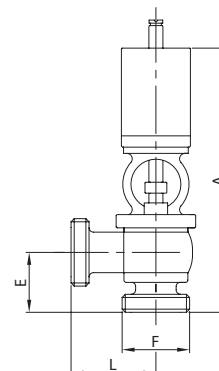

DN	A	E	F	L	gr
25	262,0	57,0	52-6	58,0	3.750
32	271,0	63,0	58-6	61,0	4.020
40	275,0	64,0	65-6	60,0	4.080
50	334,0	72,0	78-6	73,0	6.980
65	355,0	80,5	95-6	81,0	8.980
80	397,0	91,0	110-4	89,0	14.740
100	477,5	115,0	130-4	152,0	20.680

V. PNEUM. 3-A 3 V. T EF.
PNEUM. V. 3-A 3 W. T ME.
V. PNEUM. 3-A 3 V. T BF.
V. NEUM. 3-A 3 V. T ER.

906 D

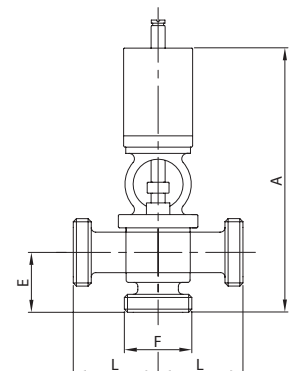

DN	A	E	F	L	gr
25	262,0	57,0	52-6	58,0	3.870
32	271,0	63,0	58-6	61,0	4.170
40	275,0	64,0	65-6	60,0	4.260
50	334,0	72,0	78-6	73,0	7.220
65	355,0	80,5	95-6	81,0	9.320
80	397,0	91,0	110-4	89,0	15.280
100	477,5	115,0	130-4	152,0	21.420

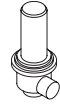

V. PNEUM. 3-A 3 V. LL EL.
PNEUM. V. 3-A 3 W. LL PE.
V. PNEUM. 3-A 3 V. LL BL.
V. NEUM. 3-A 3 V. LL EL.

910 L

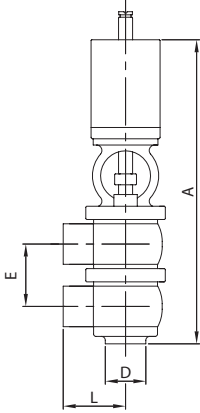

DN	A	D	E	L	gr
28	301,0	28,0	58,0	45,0	4.670
34	316,0	34,0	64,0	50,0	5.100
40	326,0	40,0	70,0	56,0	5.100
52	395,0	52,0	80,0	70,0	9.100
70	435,0	70,0	101,0	78,0	11.650
85	483,0	85,0	112,0	93,0	18.200
101	624,0	101,6	171,0	135,0	23.000

V. PNEUM. 3-A 3 V. LT EL.
PNEUM. V. 3-A 3 W. LT PE.
V. PNEUM. 3-A 3 V. LT BL.
V. NEUM. 3-A 3 V. LT EL.

915 L

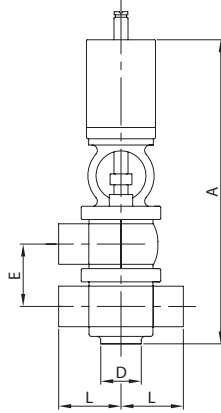

DN	A	D	E	L	gr
28	301,0	28,0	58,0	45,0	4.670
34	316,0	34,0	64,0	50,0	5.100
40	326,0	40,0	70,0	56,0	5.100
52	395,0	52,0	80,0	70,0	9.100
70	435,0	70,0	101,0	78,0	11.650
85	483,0	85,0	112,0	93,0	18.200
101	624,0	101,6	171,0	135,0	23.000

V. PNEUM. 3-A 4 V. TL EL.
PNEUM. V. 3-A 4 W. TL PE.
V. PNEUM. 3-A 4 V. TL BL.
V. NEUM. 3-A 4 V. TL EL.

920 L

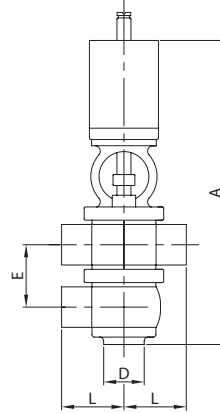

DN	A	D	E	L	gr
28	301,0	28,0	58,0	45,0	4.670
34	316,0	34,0	64,0	50,0	5.100
40	326,0	40,0	70,0	56,0	5.100
52	395,0	52,0	80,0	70,0	9.100
70	435,0	70,0	101,0	78,0	11.650
85	483,0	85,0	112,0	93,0	18.200
101	624,0	101,6	171,0	135,0	23.000

V. PNEUM. 3-A 5 V. TT EL.
PNEUM. V. 3-A 5 W. TT PE.
V. PNEUM. 3-A 5 V. TT BL.
V. NEUM. 3-A 5 V. TT EL.

925 L

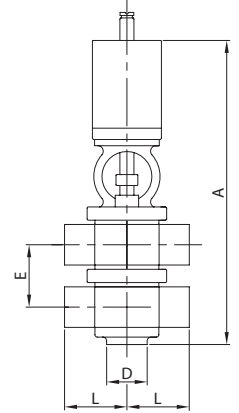

DN	A	D	E	L	gr
28	301,0	28,0	58,0	45,0	4.670
34	316,0	34,0	64,0	50,0	5.100
40	326,0	40,0	70,0	56,0	5.100
52	395,0	52,0	80,0	70,0	9.100
70	435,0	70,0	101,0	78,0	11.650
85	483,0	85,0	112,0	93,0	18.200
101	624,0	101,6	171,0	135,0	23.000

V. PNEUM. 3-A 3 V. LL EF.
PNEUM. V. 3-A 3 W. LL ME.
V. PNEUM. 3-A 3 V. LL BF.
V. NEUM. 3-A 3 V. LL ER.

911 D

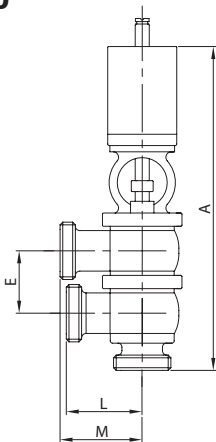

DN	A	E	L	M	gr
25	320,0	58,0	58,0	93,0	5.030
32	335,0	64,0	61,0	96,0	5.550
40	345,0	70,0	60,0	95,0	5.640
50	414,0	80,0	73,0	108,0	9.820
65	456,0	101,0	81,0	116,0	12.670
80	508,0	112,0	89,0	124,0	19.820
100	648,5	171,0	152,0	152,0	25.220

V. PNEUM. 3-A 3 V. LT EF.
PNEUM. V. 3-A 3 W. LT ME.
V. PNEUM. 3-A 3 V. LT BF.
V. NEUM. 3-A 3 V. LT ER.

916 D

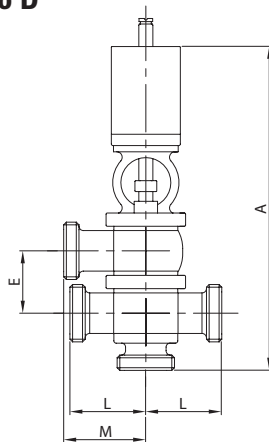

DN	A	E	L	M	gr
25	320,0	58,0	58,0	93,0	5.150
32	335,0	64,0	61,0	96,0	5.700
40	345,0	70,0	60,0	95,0	5.820
50	414,0	80,0	73,0	108,0	10.060
65	456,0	101,0	81,0	116,0	13.010
80	508,0	112,0	89,0	124,0	20.360
100	648,5	171,0	152,0	152,0	25.960

V. PNEUM. 3-A 4 V. TL EF.
PNEUM. V. 3-A 4 W. TL ME.
V. PNEUM. 3-A 4 V. TL BF.
V. NEUM. 3-A 4 V. TL ER.

921 D

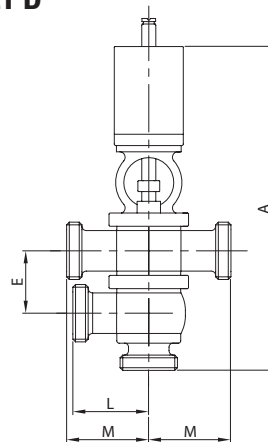

DN	A	E	L	M	gr
25	320,0	58,0	58,0	93,0	5.150
32	335,0	64,0	61,0	96,0	5.700
40	345,0	70,0	60,0	95,0	5.820
50	414,0	80,0	73,0	108,0	10.060
65	456,0	101,0	81,0	116,0	13.010
80	508,0	112,0	89,0	124,0	20.360
100	648,5	171,0	152,0	152,0	25.960

V. PNEUM. 3-A 5 V. TT EF.
PNEUM. V. 3-A 5 W. TT ME.
V. PNEUM. 3-A 5 V. TT BF.
V. NEUM. 3-A 5 V. TT ER.

926 D

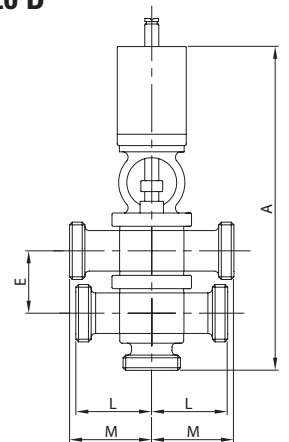

DN	A	E	L	M	gr
25	320,0	58,0	58,0	93,0	5.270
32	335,0	64,0	61,0	96,0	5.850
40	345,0	70,0	60,0	95,0	6.000
50	414,0	80,0	73,0	108,0	10.300
65	456,0	101,0	81,0	116,0	13.350
80	508,0	112,0	89,0	124,0	20.900
100	648,5	171,0	152,0	152,0	26.700

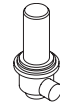

V. MANUALE 2 V. L EL.
MANUAL V. 2 W. L PE.
V. MANUELLE 2 V. L BL.
V. MANUAL 2 V. L EL.

850 L

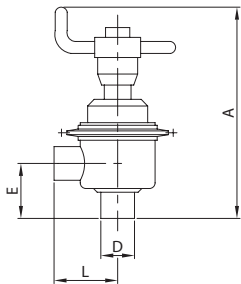

DN	A	D	E	L	gr
28	245,0	28,0	44,5	66,5	2.150
34	254,0	34,0	53,0	66,5	2.170
40	250,0	40,0	49,0	66,5	2.170
52	290,0	52,0	58,0	74,0	2.880
70	365,0	70,0	71,0	95,0	4.500
85	388,0	85,0	83,0	95,0	7.750

V. MANUALE 3 V. T EL.
MANUAL V. 3 W. T PE.
V. MANUELLE 3 V. T BL.
V. MANUAL 3 V. T EL.

855 L

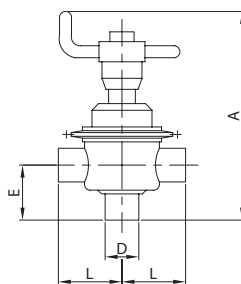

DN	A	D	E	L	gr
28	245,0	28,0	44,5	66,5	2.200
34	254,0	34,0	53,0	66,5	2.190
40	250,0	40,0	49,0	66,5	2.200
52	290,0	52,0	58,0	74,0	2.730
70	365,0	70,0	71,0	95,0	4.780
85	388,0	85,0	83,0	95,0	7.840

V. MANUALE 3 V. LL EL.
MANUAL V. 3 W. LL PE.
V. MANUELLE 3 V. LL BL.
V. MANUAL 3 V. LL EL.

860 L

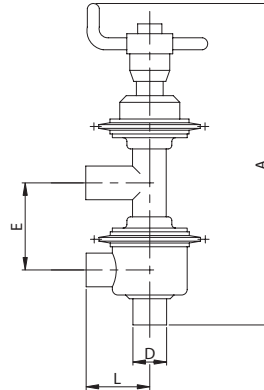

DN	A	D	E	L	gr
28	326,0	28,0	81,0	66,5	2.540
34	335,0	34,0	81,0	66,5	2.550
40	331,0	40,0	81,0	66,5	2.560
52	385,0	52,0	95,0	74,0	3.230
70	480,0	70,0	115,0	95,0	5.850
85	519,0	85,0	131,0	95,0	9.100

V. MANUALE 4 V. LT EL.
MANUAL V. 4 W. LT PE.
V. MANUELLE 4 V. LT BL.
V. MANUAL 4 V. LT EL.

865 L

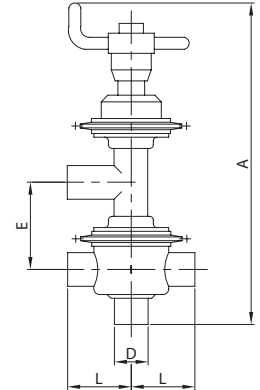

DN	A	D	E	L	gr
28	326,0	28,0	81,0	66,5	2.600
34	335,0	34,0	81,0	66,5	2.610
40	331,0	40,0	81,0	66,5	2.600
52	385,0	52,0	95,0	74,0	3.260
70	480,0	70,0	115,0	95,0	5.950
85	519,0	85,0	131,0	95,0	9.250

V. MANUALE 2 V. L EF.
MANUAL V. 2 W. L ME.
V. MANUELLE 2 V. L BF.
V. MANUAL 2 V. L ER.

851 D

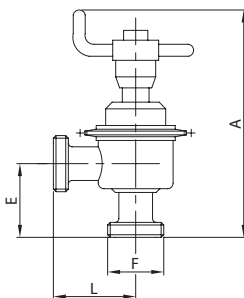

DN	A	E	F	L	gr
25	259,0	59,0	52-6	81,0	2.300
32	268,0	67,0	58-6	81,0	2.350
40	263,0	62,0	65-6	80,0	2.400
50	303,0	71,0	78-6	87,0	2.990
65	380,0	86,0	95-6	110,0	4.950
80	405,0	100,0	110-4	112,0	8.350

V. MANUALE 3 V. T EF.
MANUAL V. 3 W. T ME.
V. MANUELLE 3 V. T BF.
V. MANUAL 3 V. T ER.

856 D

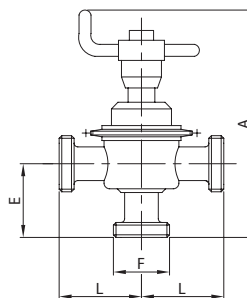

DN	A	E	F	L	gr
25	259,0	59,0	52-6	81,0	2.380
32	268,0	67,0	58-6	81,0	2.450
40	263,0	62,0	65-6	80,0	2.520
50	303,0	71,0	78-6	87,0	3.150
65	380,0	86,0	95-6	110,0	5.300
80	405,0	100,0	110-4	112,0	8.740

V. MANUALE 3 V. LL EF.
MANUAL V. 3 W. LL ME.
V. MANUELLE 3 V. LL BF.
V. MANUAL 3 V. LL ER.

861 D

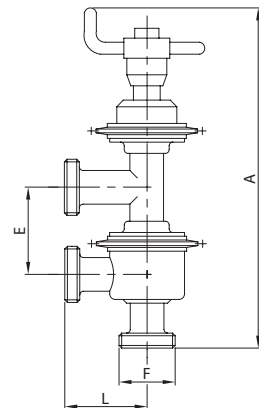

DN	A	E	F	L	gr
25	340,0	81,0	52-6	81,0	2.740
32	349,0	81,0	58-6	81,0	2.800
40	344,0	81,0	65-6	80,0	2.890
50	398,0	95,0	78-6	87,0	3.650
65	495,0	115,0	95-6	110,0	6.420
80	536,0	131,0	110-4	112,0	10.000

V. MANUALE 4 V. LT EF.
MANUAL V. 4 W. LT ME.
V. MANUELLE 4 V. LT BF.
V. MANUAL 4 V. LT ER.

866 D

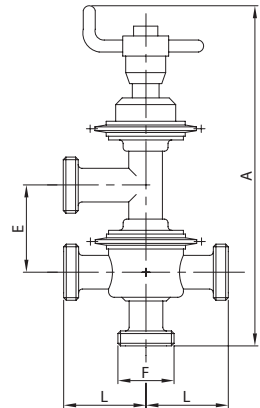

DN	A	E	F	L	gr
25	340,0	81,0	52-6	81,0	2.840
32	349,0	81,0	58-6	81,0	2.920
40	344,0	81,0	65-6	80,0	3.020
50	398,0	95,0	78-6	87,0	3.820
65	495,0	115,0	95-6	110,0	6.710
80	536,0	131,0	110-4	112,0	10.450

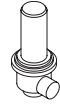

V. PNEUMATICA 2 V. L EL.
PNEUMATIC V. 2 W. L PE.
V. PNEUMATIQUE 2 V. L BL.
V. NEUMÁTICA 2 V. L EL.

800 L

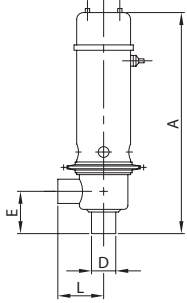

DN	A	D	E	L	gr
25	373,5	25,4	50,5	66,5	4.370
38	373,0	38,1	50,0	66,5	4.360
51	377,5	50,8	58,5	74,0	5.400
63	424,5	63,5	67,5	95,0	9.050
76	435,0	76,2	76,0	95,0	9.470
101	543,0	101,6	98,0	135,0	19.850

V. PNEUMATICA 3 V. T EL.
PNEUMATIC V. 3 W. T PE.
V. PNEUMATIQUE 3 V. T BL.
V. NEUMÁTICA 3 V. T EL.

805 L

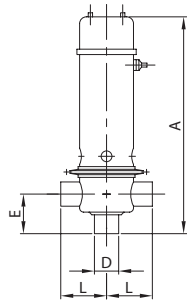

DN	A	D	E	L	gr
25	373,5	25,4	50,5	66,5	4.390
38	373,5	38,1	50,0	66,5	4.400
51	377,5	50,8	58,5	74,0	5.450
63	424,5	63,5	67,5	95,0	9.400
76	435,0	76,2	76,0	95,0	9.480
101	543,0	101,6	98,0	135,0	19.980

V. PNEUMATICA 3 V. LL EL.
PNEUMATIC V. 3 W. LL PE.
V. PNEUMATIQUE 3 V. LL BL.
V. NEUMÁTICA 3 V. LL EL.

810 L

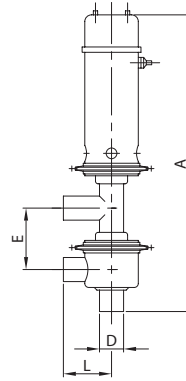

DN	A	D	E	L	gr
25	454,5	25,4	81,0	66,5	5.075
38	454,0	38,1	81,0	66,5	5.110
51	472,5	50,8	95,0	74,0	6.460
63	539,5	63,5	115,0	95,0	11.500
76	566,0	76,2	131,0	95,0	11.900
101	700,0	101,6	157,0	135,0	24.280

V. PNEUMATICA 4 V. LT EL.
PNEUMATIC V. 4 W. LT PE.
V. PNEUMATIQUE 4 V. LT BL.
V. NEUMÁTICA 4 V. LT EL.

815 L

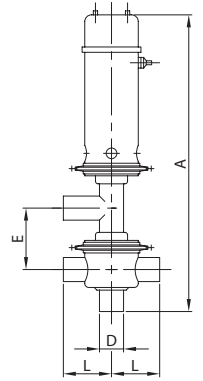

DN	A	D	E	L	gr
25	454,5	25,4	81,0	66,5	5.075
38	454,0	38,1	81,0	66,5	5.110
51	472,5	50,8	95,0	74,0	6.460
63	539,5	63,5	115,0	95,0	11.500
76	566,0	76,2	131,0	95,0	11.900
101	700,0	101,6	157,0	135,0	24.280

V. PNEUMATICA 2 V. L EF.
PNEUMATIC V. 2 W. L ME.
V. PNEUMATIQUE 2 V. L BF.
V. NEUMÁTICA 2 V. L ER.

801 S

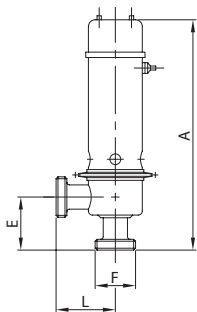

DN	A	E	F	L	gr
25	373,5	50,5	40-6	66,5	4.510
38	373,0	50,0	60-6	66,5	4.760
51	377,5	58,5	70-6	74,0	5.850
63	424,5	67,5	85-6	95,0	9.830
76	435,0	76,0	98-6	95,0	10.470
101	543,0	98,0	132-6	135,0	22.130

V. PNEUMATICA 3 V. T EF.
PNEUMATIC V. 3 W. T ME.
V. PNEUMATIQUE 3 V. T BF.
V. NEUMÁTICA 3 V. T ER.

806 S

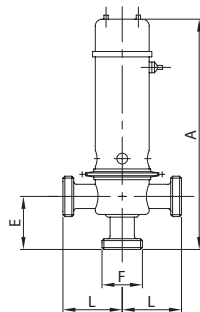

DN	A	E	F	L	gr
25	373,5	50,5	40-6	66,5	4.600
38	373,0	50,0	60-6	66,5	5.000
51	377,5	58,5	70-6	74,0	6.125
63	424,5	67,5	85-6	95,0	10.570
76	435,0	76,0	98-6	95,0	10.980
101	543,0	98,0	132-6	135,0	23.400

V. PNEUMATICA 3 V. LL EF.
PNEUMATIC V. 3 W. LL ME.
V. PNEUMATIQUE 3 V. LL BF.
V. NEUMÁTICA 3 V. LL ER.

811 S

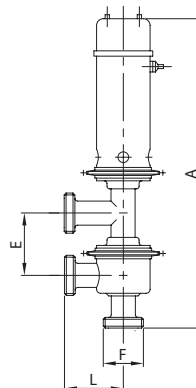

DN	A	E	F	L	gr
25	454,5	81,0	40-6	66,5	5.285
38	454,0	81,0	60-6	66,5	5.710
51	472,5	95,0	70-6	74,0	7.135
63	539,5	115,0	85-6	95,0	12.670
76	566,0	131,0	98-6	95,0	13.400
101	700,0	157,0	132-6	135,0	27.700

V. PNEUMATICA 4 V. LT EF.
PNEUMATIC V. 4 W. LT ME.
V. PNEUMATIQUE 4 V. LT BF.
V. NEUMÁTICA 4 V. LT ER.

816 S

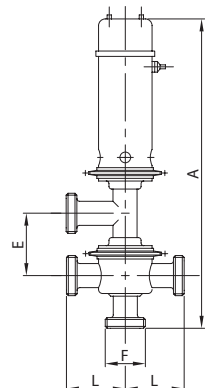

DN	A	E	F	L	gr
25	454,5	81,0	40-6	66,5	5.285
38	454,0	81,0	60-6	66,5	5.710
51	472,5	95,0	70-6	74,0	7.135
63	539,5	115,0	85-6	95,0	12.670
76	566,0	131,0	98-6	95,0	13.400
101	700,0	157,0	132-6	135,0	27.700

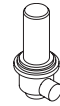

V. PNEUMATICA 4 V. TL EL.
PNEUMATIC V. 4 W. TL PE.
V. PNEUMATIQUE 4 V. TL BL.
V. NEUMÁTICA 4 V. TL EL.

820 L

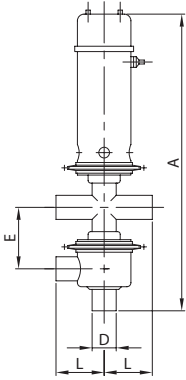

DN	A	D	E	L	gr
25	454,5	25,4	81,0	66,5	5.140
38	454,0	38,1	81,0	66,5	5.190
51	472,5	50,8	95,0	74,0	6.500
63	539,5	63,5	115,0	95,0	11.800
76	566,0	76,2	131,0	95,0	12.400
101	700,0	101,6	157,0	135,0	24.450

V. PNEUMATICA 5 V. TT EL.
PNEUMATIC V. 5 W. TT PE.
V. PNEUMATIQUE 5 V. TT BL.
V. NEUMÁTICA 5 V. TT EL.

825 L

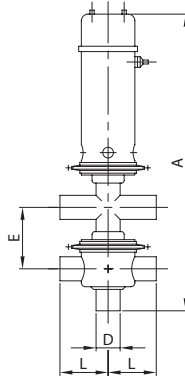

DN	A	D	E	L	gr
25	454,5	25,4	81,0	66,5	5.140
38	454,0	38,1	81,0	66,5	5.190
51	472,5	50,8	95,0	74,0	6.500
63	539,5	63,5	115,0	95,0	11.800
76	566,0	76,2	131,0	95,0	12.400
101	700,0	101,6	157,0	135,0	24.450

V. PNEUM. 3-A 2 V. L EL.
PNEUM. V. 3-A 2 W. L PE.
V. PNEUM. 3-A 2 V. L BL.
V. NEUM. 3-A 2 V. L EL.

900 L

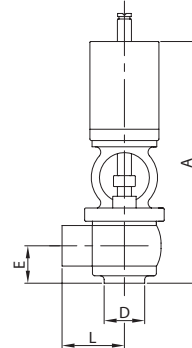

DN	A	D	E	L	gr
25	241,0	25,4	38,0	45,0	3.510
38	253,0	38,1	43,5	56,0	3.720
51	315,0	50,8	53,0	70,0	6.500
63	329,0	63,5	57,0	78,0	8.250
76	366,0	76,2	65,5	85,0	10.850
101	453,0	101,6	90,5	135,0	19.200

V. PNEUM. 3-A 3 V. T EL.
PNEUM. V. 3-A 3 W. T PE.
V. PNEUM. 3-A 3 V. T BL.
V. NEUM. 3-A 3 V. T EL.

905 L

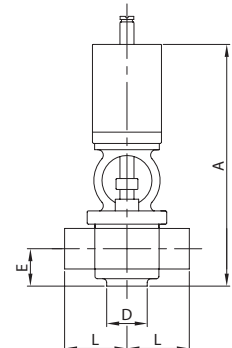

DN	A	D	E	L	gr
25	241,0	25,4	38,0	45,0	3.510
38	253,0	38,1	43,5	56,0	3.720
51	315,0	50,8	53,0	70,0	6.500
63	329,0	63,5	57,0	78,0	8.250
76	366,0	76,2	65,5	85,0	10.850
101	453,0	101,6	90,5	135,0	19.200

V. PNEUMATICA 4 V. TL EF.
PNEUMATIC V. 4 W. TL ME.
V. PNEUMATIQUE 4 V. TL BF.
V. NEUMÁTICA 4 V. TL ER.

821 S

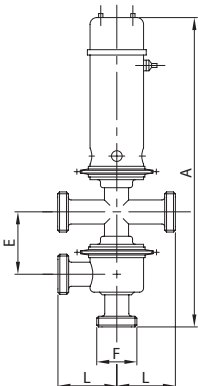

DN	A	E	F	L	gr
25	454,5	81,0	40-6	66,5	5.420
38	454,0	81,0	60-6	66,5	5.990
51	472,5	95,0	70-6	74,0	7.400
63	539,5	115,0	85-6	95,0	13.360
76	566,0	131,0	98-6	95,0	14.400
101	700,0	157,0	132-6	135,0	29.010

V. PNEUMATICA 5 V. TT EF.
PNEUMATIC V. 5 W. TT ME.
V. PNEUMATIQUE 5 V. TT BF.
V. NEUMÁTICA 5 V. TT ER.

826 S

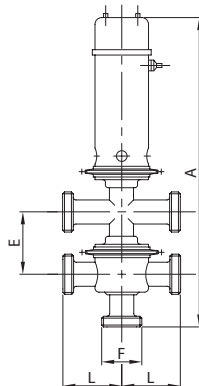

DN	A	E	F	L	gr
25	454,5	81,0	40-6	66,5	5.420
38	454,0	81,0	60-6	66,5	5.990
51	472,5	95,0	70-6	74,0	7.400
63	539,5	115,0	85-6	95,0	13.360
76	566,0	131,0	98-6	95,0	14.400
101	700,0	157,0	132-6	135,0	29.010

V. PNEUM. 3-A 2 V. L EF.
PNEUM. V. 3-A 2 W. L ME.
V. PNEUM. 3-A 2 V. L BF.
V. NEUM. 3-A 2 V. L ER.

901 S

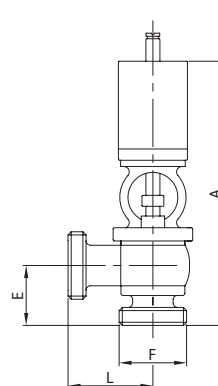

DN	A	E	F	L	gr
25	256,0	53,0	40-6	58,0	3.630
38	273,0	63,5	60-6	60,0	4.080
51	335,0	73,0	70-6	73,0	6.880
63	353,0	81,0	85-6	81,0	8.950
76	390,0	89,5	98-6	89,0	11.770
101	477,5	115,0	132-6	160,0	21.000

V. PNEUM. 3-A 3 V. T EF.
PNEUM. V. 3-A 3 W. T ME.
V. PNEUM. 3-A 3 V. T BF.
V. NEUM. 3-A 3 V. T ER.

906 S

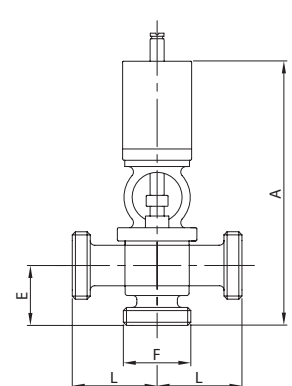

DN	A	E	F	L	gr
25	256,0	53,0	40-6	58,0	3.690
38	273,0	63,5	60-6	60,0	4.260
51	335,0	73,0	70-6	73,0	7.070
63	355,0	81,0	85-6	81,0	9.300
76	390,0	89,5	98-6	89,0	12.230
101	477,5	115,0	132-6	160,0	21.900

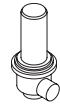

V. PNEUM. 3-A 3 V. LL EL.
PNEUM. V. 3-A 3 W. LL PE.
V. PNEUM. 3-A 3 V. LL BL.
V. NEUM. 3-A 3 V. LL EL.

910 L

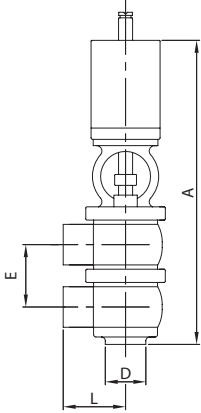

DN	A	D	E	L	gr
25	295,0	25,4	54,0	45,0	4.670
38	320,0	38,1	67,0	56,0	5.100
51	395,0	50,8	80,0	70,0	9.100
63	425,0	63,5	96,0	78,0	11.000
76	469,0	76,2	103,0	85,0	15.100
101	624,0	101,6	171,0	135,0	23.000

V. PNEUM. 3-A 3 V. LT EL.
PNEUM. V. 3-A 3 W. LT PE.
V. PNEUM. 3-A 3 V. LT BL.
V. NEUM. 3-A 3 V. LT EL.

915 L

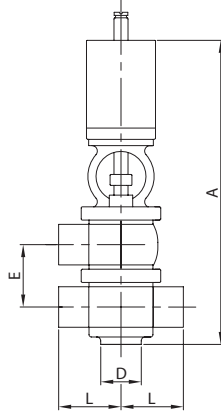

DN	A	D	E	L	gr
25	295,0	25,4	54,0	45,0	4.670
38	320,0	38,1	67,0	56,0	5.100
51	395,0	50,8	80,0	70,0	9.100
63	425,0	63,5	96,0	78,0	11.000
76	469,0	76,2	103,0	85,0	15.100
101	624,0	101,6	171,0	135,0	23.000

V. PNEUM. 3-A 4 V. TL EL.
PNEUM. V. 3-A 4 W. TL PE.
V. PNEUM. 3-A 4 V. TL BL.
V. NEUM. 3-A 4 V. TL EL.

920 L

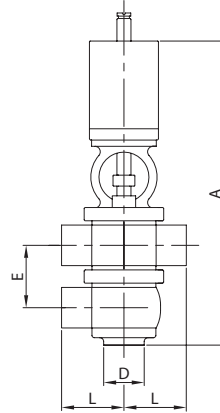

DN	A	D	E	L	gr
25	295,0	25,4	54,0	45,0	4.670
38	320,0	38,1	67,0	56,0	5.100
51	395,0	50,8	80,0	70,0	9.100
63	425,0	63,5	96,0	78,0	11.000
76	469,0	76,2	103,0	85,0	15.100
101	624,0	101,6	171,0	135,0	23.000

V. PNEUM. 3-A 5 V. TT EL.
PNEUM. V. 3-A 5 W. TT PE.
V. PNEUM. 3-A 5 V. TT BL.
V. NEUM. 3-A 5 V. TT EL.

925 L

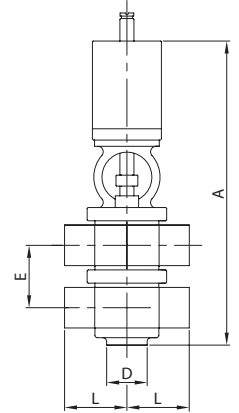

DN	A	D	E	L	gr
25	295,0	25,4	54,0	45,0	4.670
38	320,0	38,1	67,0	56,0	5.100
51	395,0	50,8	80,0	70,0	9.100
63	425,0	63,5	96,0	78,0	11.000
76	469,0	76,2	103,0	85,0	15.100
101	624,0	101,6	171,0	135,0	23.000

V. PNEUM. 3-A 3 V. LL EF.
PNEUM. V. 3-A 3 W. LL ME.
V. PNEUM. 3-A 3 V. LL BF.
V. NEUM. 3-A 3 V. LL ER.

911 S

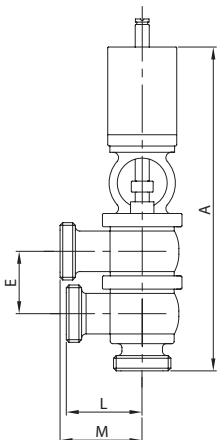

DN	A	E	L	M	gr
25	310,0	54,0	58,0	93,0	4.850
38	340,0	67,0	60,0	95,0	5.640
51	415,0	80,0	73,0	108,0	9.670
63	449,0	96,0	81,0	116,0	12.050
76	493,0	103,0	89,0	124,0	16.480
101	648,5	171,0	160,0	160,0	25.700

V. PNEUM. 3-A 3 V. LT EF.
PNEUM. V. 3-A 3 W. LT ME.
V. PNEUM. 3-A 3 V. LT BF.
V. NEUM. 3-A 3 V. LT ER.

916 S

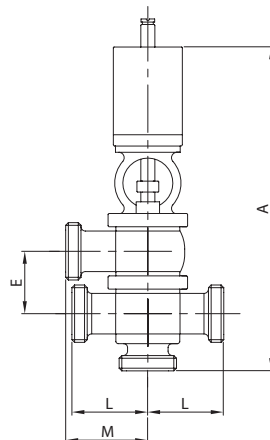

DN	A	E	L	M	gr
25	310,0	54,0	58,0	93,0	4.910
38	340,0	67,0	60,0	95,0	5.820
51	415,0	80,0	73,0	108,0	9.860
63	449,0	96,0	81,0	116,0	12.400
76	493,0	103,0	89,0	124,0	16.940
101	648,5	171,0	160,0	160,0	26.600

V. PNEUM. 3-A 4 V. TL EF.
PNEUM. V. 3-A 4 W. TL ME.
V. PNEUM. 3-A 4 V. TL BF.
V. NEUM. 3-A 4 V. TL ER.

921 S

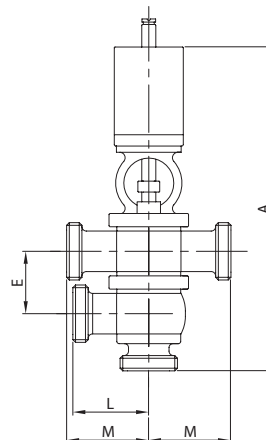

DN	A	E	L	M	gr
25	310,0	54,0	58,0	93,0	4.910
38	340,0	67,0	60,0	95,0	5.820
51	415,0	80,0	73,0	108,0	9.860
63	449,0	96,0	81,0	116,0	12.400
76	493,0	103,0	89,0	124,0	16.940
101	648,5	171,0	160,0	160,0	26.600

V. PNEUM. 3-A 5 V. TT EF.
PNEUM. V. 3-A 5 W. TT ME.
V. PNEUM. 3-A 5 V. TT BF.
V. NEUM. 3-A 5 V. TT ER.

926 S

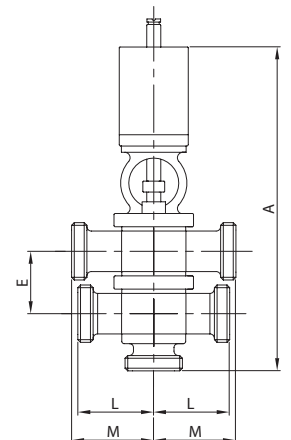

DN	A	E	L	M	gr
25	310,0	54,0	58,0	93,0	4.970
38	340,0	67,0	60,0	95,0	6.000
51	415,0	80,0	73,0	108,0	10.050
63	449,0	96,0	81,0	116,0	12.750
76	493,0	103,0	89,0	124,0	17.400
101	648,5	171,0	160,0	160,0	27.500

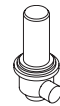

V. MANUALE 2 V. L EL.
MANUAL V. 2 W. L PE.
V. MANUELLE 2 V. L BL.
V. MANUAL 2 V. L EL.

V. MANUALE 3 V. T EL.
MANUAL V. 3 W. T PE.
V. MANUELLE 3 V. T BL.
V. MANUAL 3 V. T EL.

V. MANUALE 3 V. LL EL.
MANUAL V. 3 W. LL PE.
V. MANUELLE 3 V. LL BL.
V. MANUAL 3 V. LL EL.

V. MANUALE 4 V. LT EL.
MANUAL V. 4 W. LT PE.
V. MANUELLE 4 V. LT BL.
V. MANUAL 4 V. LT EL.

850 L

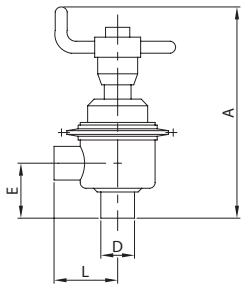

855 L

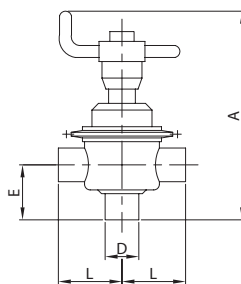

860 L

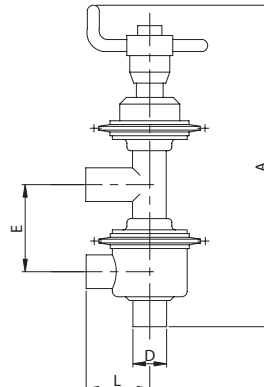

865 L

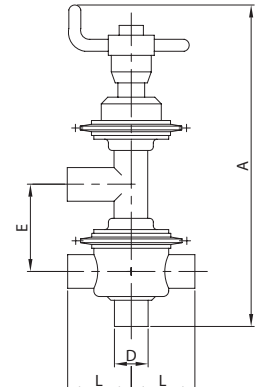

DN	A	D	E	L	gr
25	251,5	25,4	50,5	66,5	2.185
38	251,0	38,1	50,0	66,5	2.180
51	290,0	50,8	58,5	74,0	2.700
63	361,0	63,5	67,5	95,0	4.530
76	372,0	76,2	76,0	95,0	4.740

DN	A	D	E	L	gr
25	251,5	25,4	50,5	66,5	2.200
38	251,0	38,1	50,0	66,5	2.200
51	290,0	50,8	58,5	74,0	2.730
63	361,0	63,5	67,5	95,0	4.700
76	372,0	76,2	76,0	95,0	4.740

DN	A	D	E	L	gr
25	332,5	25,4	81,0	66,5	2.540
38	332,0	38,1	81,0	66,5	2.560
51	385,0	50,8	95,0	74,0	3.230
63	476,0	63,5	115,0	95,0	5.750
76	503,0	76,2	131,0	95,0	5.950

DN	A	D	E	L	gr
25	332,5	25,4	81,0	66,5	2.570
38	332,0	38,1	81,0	66,5	2.600
51	385,0	50,8	95,0	74,0	3.250
63	476,0	63,5	115,0	95,0	5.900
76	503,0	76,2	131,0	95,0	6.200

V. MANUALE 2 V. L EF.
MANUAL V. 2 W. L ME.
V. MANUELLE 2 V. L BF.
V. MANUAL 2 V. L ER.

V. MANUALE 3 V. T EF.
MANUAL V. 3 W. T ME.
V. MANUELLE 3 V. T BF.
V. MANUAL 3 V. T ER.

V. MANUALE 3 V. LL EF.
MANUAL V. 3 W. LL ME.
V. MANUELLE 3 V. LL BF.
V. MANUAL 3 V. LL ER.

V. MANUALE 4 V. LT EF.
MANUAL V. 4 W. LT ME.
V. MANUELLE 4 V. LT BF.
V. MANUAL 4 V. LT ER.

851 S

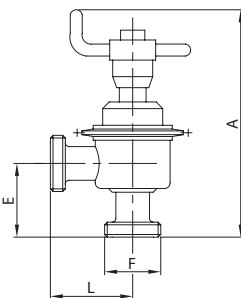

856 S

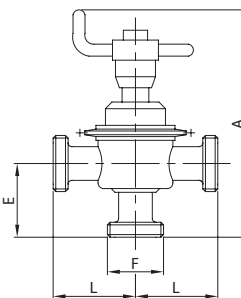

861 S

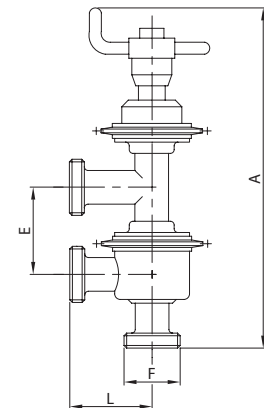

866 S

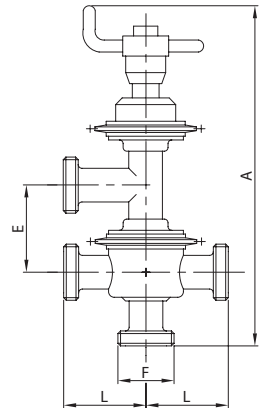

DN	A	E	F	L	gr
25	251,5	50,5	40-6	66,5	2.260
38	251,0	50,0	60-6	66,5	2.380
51	290,0	58,5	70-6	74,0	2.930
63	361,0	67,5	85-6	95,0	4.900
76	372,0	76,0	98-6	95,0	5.240

DN	A	E	F	L	gr
25	251,5	50,5	40-6	66,5	2.300
38	251,0	50,0	60-6	66,5	2.500
51	290,0	58,5	70-6	74,0	3.100
63	361,0	67,5	85-6	95,0	5.300
76	372,0	76,0	98-6	95,0	5.420

DN	A	E	F	L	gr
25	332,5	81,0	40-6	66,5	2.645
38	332,0	81,0	60-6	66,5	2.850
51	385,0	95,0	70-6	74,0	3.570
63	476,0	115,0	85-6	95,0	6.340
76	503,0	131,0	98-6	95,0	6.700

DN	A	E	F	L	gr
25	332,5	81,0	40-6	66,5	2.710
38	332,0	81,0	60-6	66,5	3.000
51	385,0	95,0	70-6	74,0	3.700
63	476,0	115,0	85-6	95,0	6.680
76	503,0	131,0	98-6	95,0	7.200

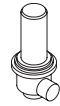

V. PNEUMATICA 2 V. L EL.
PNEUMATIC V. 2 W. L PE.
V. PNEUMATIQUE 2 V. L BL.
V. NEUMÁTICA 2 V. L EL.

800 L

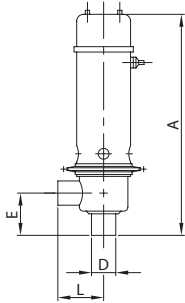

DN	A	D	E	L	gr
25	373,5	25,4	50,5	66,5	4.370
38	373,0	38,1	50,0	66,5	4.360
51	377,5	50,8	58,5	74,0	5.400
63	424,5	63,5	67,5	95,0	9.050
76	435,0	76,2	76,0	95,0	9.470
101	543,0	101,6	98,0	135,0	19.850

V. PNEUMATICA 3 V. T EL.
PNEUMATIC V. 3 W. T PE.
V. PNEUMATIQUE 3 V. T BL.
V. NEUMÁTICA 3 V. T EL.

805 L

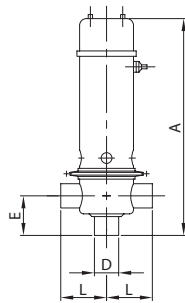

DN	A	D	E	L	gr
25	373,5	25,4	50,5	66,5	4.390
38	373,0	38,1	50,0	66,5	4.400
51	377,5	50,8	58,5	74,0	5.450
63	424,5	63,5	67,5	95,0	9.400
76	435,0	76,2	76,0	95,0	9.480
101	543,0	101,6	98,0	135,0	19.980

V. PNEUMATICA 3 V. LL EL.
PNEUMATIC V. 3 W. LL PE.
V. PNEUMATIQUE 3 V. LL BL.
V. NEUMÁTICA 3 V. LL EL.

810 L

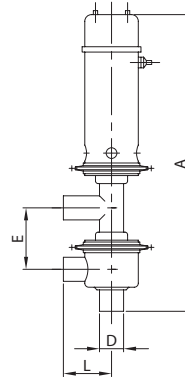

DN	A	D	E	L	gr
25	454,5	25,4	81,0	66,5	5.075
38	454,0	38,1	81,0	66,5	5.110
51	472,5	50,8	95,0	74,0	6.460
63	539,5	63,5	115,0	95,0	11.500
76	566,0	76,2	131,0	95,0	11.900
101	700,0	101,6	157,0	135,0	24.280

V. PNEUMATICA 4 V. LT EL.
PNEUMATIC V. 4 W. LT PE.
V. PNEUMATIQUE 4 V. LT BL.
V. NEUMÁTICA 4 V. LT EL.

815 L

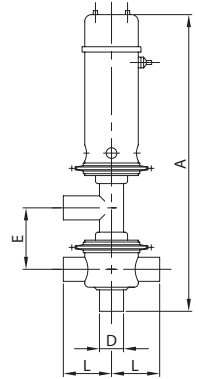

DN	A	D	E	L	gr
25	454,5	25,4	81,0	66,5	5.075
38	454,0	38,1	81,0	66,5	5.110
51	472,5	50,8	95,0	74,0	6.460
63	539,5	63,5	115,0	95,0	11.500
76	566,0	76,2	131,0	95,0	11.900
101	700,0	101,6	157,0	135,0	24.280

V. PNEUMATICA 2 V. L EF.
PNEUMATIC V. 2 W. L ME.
V. PNEUMATIQUE 2 V. L BF.
V. NEUMÁTICA 2 V. L ER.

801 B

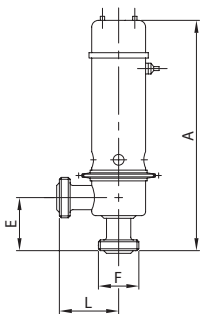

DN	A	E	F	L	gr
25	405,0	69,5	46-8	85,5	4.570
38	404,5	69,0	58-8	85,5	4.670
51	409,0	77,5	73-6	93,0	5.870
63	456,0	86,5	85-6	114,0	9.630
76	466,5	95,0	98-6	114,0	10.200
101	574,5	117,0	123-6	154,0	20.910

V. PNEUMATICA 3 V. T EF.
PNEUMATIC V. 3 W. T ME.
V. PNEUMATIQUE 3 V. T BF.
V. NEUMÁTICA 3 V. T ER.

806 B

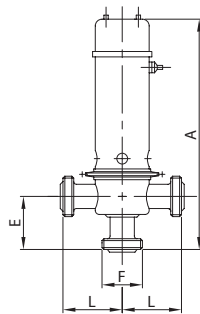

DN	A	E	F	L	gr
25	405,0	69,5	46-8	85,5	4.590
38	404,5	69,0	58-8	85,5	4.865
51	409,0	77,5	73-6	93,0	6.155
63	456,0	86,5	85-6	114,0	10.270
76	466,5	95,0	98-6	114,0	10.575
101	574,5	117,0	123-6	154,0	21.570

V. PNEUMATICA 3 V. LL EF.
PNEUMATIC V. 3 W. LL ME.
V. PNEUMATIQUE 3 V. LL BF.
V. NEUMÁTICA 3 V. LL ER.

811 B

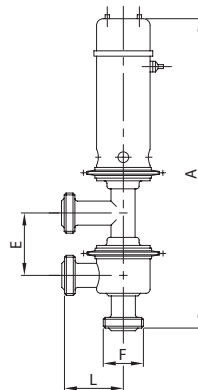

DN	A	E	F	L	gr
25	486,0	81,0	46-8	85,5	5.375
38	485,5	81,0	58-8	85,5	5.575
51	504,0	95,0	73-6	93,0	7.165
63	571,0	115,0	85-6	114,0	12.370
76	597,0	131,0	98-6	114,0	12.995
101	731,5	157,0	123-6	154,0	25.870

V. PNEUMATICA 4 V. LT EF.
PNEUMATIC V. 4 W. LT ME.
V. PNEUMATIQUE 4 V. LT BF.
V. NEUMÁTICA 4 V. LT ER.

816 B

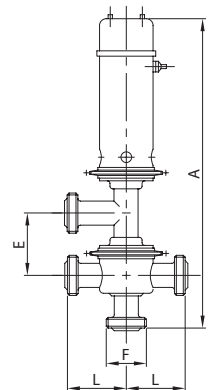

DN	A	E	F	L	gr
25	486,0	81,0	46-8	85,5	5.375
38	485,5	81,0	58-8	85,5	5.575
51	504,0	95,0	73-6	93,0	7.165
63	571,0	115,0	85-6	114,0	12.370
76	597,0	131,0	98-6	114,0	12.995
101	731,5	157,0	123-6	154,0	25.870

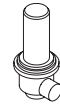

V. PNEUMATICA 4 V. TL EL.
PNEUMATIC V. 4 W. TL PE.
V. PNEUMATIQUE 4 V. TL BL.
V. NEUMÁTICA 4 V. TL EL.

820 L

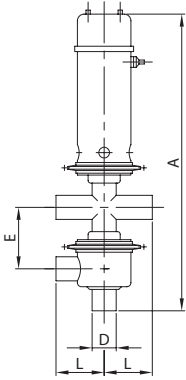

DN	A	D	E	L	gr
25	454,5	25,4	81,0	66,5	5.140
38	454,0	38,1	81,0	66,5	5.190
51	472,5	50,8	95,0	74,0	6.500
63	539,5	63,5	115,0	95,0	11.800
76	566,0	76,2	131,0	95,0	12.400
101	700,0	101,6	157,0	135,0	24.450

V. PNEUMATICA 5 V. TT EL.
PNEUMATIC V. 5 W. TT PE.
V. PNEUMATIQUE 5 V. TT BL.
V. NEUMÁTICA 5 V. TT BL.

825 L

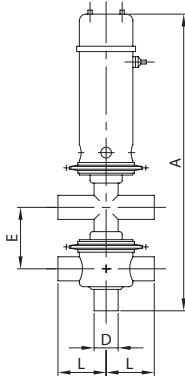

DN	A	D	E	L	gr
25	454,5	25,4	81,0	66,5	5.140
38	454,0	38,1	81,0	66,5	5.190
51	472,5	50,8	95,0	74,0	6.500
63	539,5	63,5	115,0	95,0	11.800
76	566,0	76,2	131,0	95,0	12.400
101	700,0	101,6	157,0	135,0	24.450

V. PNEUM. 3-A 2 V. L EL.
PNEUM. V. 3-A 2 W. L PE.
V. PNEUM. 3-A 2 V. L BL.
V. NEUM. 3-A 2 V. L EL.

900 L

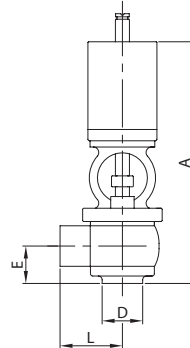

DN	A	D	E	L	gr
25	241,0	25,4	38,0	45,0	3.510
38	253,0	38,1	43,5	56,0	3.720
51	315,0	50,8	53,0	70,0	6.500
63	329,0	63,5	57,0	78,0	8.250
76	366,0	76,2	65,5	85,0	10.850
101	453,0	101,6	90,5	135,0	19.200

V. PNEUM. 3-A 3 V. T EL.
PNEUM. V. 3-A 3 W. T PE.
V. PNEUM. 3-A 3 V. T BL.
V. NEUM. 3-A 3 V. T EL.

905 L

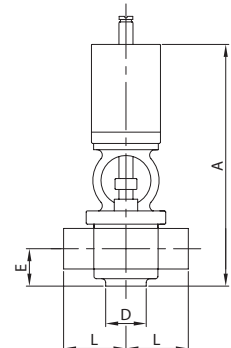

DN	A	D	E	L	gr
25	241,0	25,4	38,0	45,0	3.510
38	253,0	38,1	43,5	56,0	3.720
51	315,0	50,8	53,0	70,0	6.500
63	329,0	63,5	57,0	78,0	8.250
76	366,0	76,2	65,5	85,0	10.850
101	453,0	101,6	90,5	135,0	19.200

V. PNEUMATICA 4 V. TL EF.
PNEUMATIC V. 4 W. TL ME.
V. PNEUMATIQUE 4 V. TL BF.
V. NEUMÁTICA 4 V. TL ER.

821 B

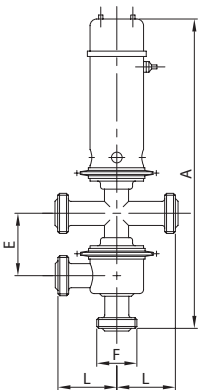

DN	A	E	F	L	gr
25	486,0	81,0	46-8	85,5	5.540
38	485,5	81,0	58-8	85,5	5.810
51	504,0	95,0	73-6	93,0	7.440
63	571,0	115,0	85-6	114,0	12.960
76	597,0	131,0	98-6	114,0	13.860
101	731,5	157,0	123-6	154,0	26.570

V. PNEUMATICA 5 V. TT EF.
PNEUMATIC V. 5 W. TT ME.
V. PNEUMATIQUE 5 V. TT BF.
V. NEUMÁTICA 5 V. TT ER.

826 B

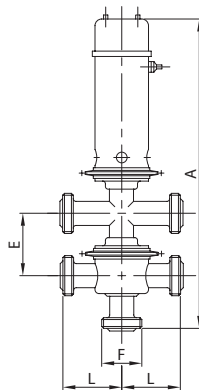

DN	A	E	F	L	gr
25	486,0	81,0	46-8	85,5	5.540
38	485,5	81,0	58-8	85,5	5.810
51	504,0	95,0	73-6	93,0	7.440
63	571,0	115,0	85-6	114,0	12.960
76	597,0	131,0	98-6	114,0	13.860
101	731,5	157,0	123-6	154,0	26.570

V. PNEUM. 3-A 2 V. L EF.
PNEUM. V. 3-A 2 W. L ME.
V. PNEUM. 3-A 2 V. L BF.
V. NEUM. 3-A 2 V. L ER.

901 B

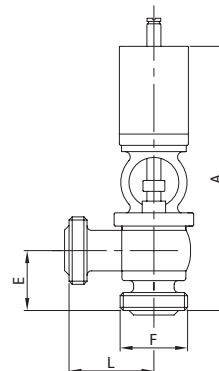

DN	A	E	F	L	gr
25	264,7	61,7	46-8	58,0	3.740
38	276,7	67,2	58-8	60,0	4.050
51	338,7	76,7	73-6	73,0	6.940
63	352,7	80,7	85-6	81,0	8.840
76	389,7	89,2	98-6	89,0	11.560
101	476,7	114,2	123-6	158,7	20.200

V. PNEUM. 3-A 3 V. T EF.
PNEUM. V. 3-A 3 W. T ME.
V. PNEUM. 3-A 3 V. T BF.
V. NEUM. 3-A 3 V. T ER.

906 B

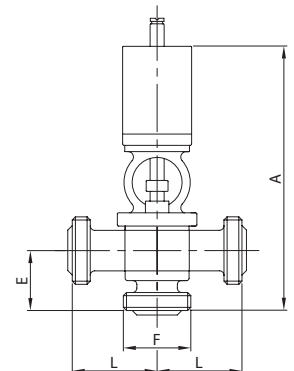

DN	A	E	F	L	gr
25	264,7	61,7	46-8	58,0	3.855
38	276,7	67,2	58-8	60,0	4.215
51	338,7	76,7	73-6	73,0	7.160
63	352,7	80,7	85-6	81,0	9.135
76	389,7	89,2	98-6	89,0	11.915
101	476,7	114,2	123-6	158,7	20.700

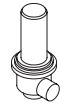

V. PNEUM. 3-A 3 V. LL EL.
PNEUM. V. 3-A 3 W. LL PE.
V. PNEUM. 3-A 3 V. LL BL.
V. NEUM. 3-A 3 V. LL EL.

910 L

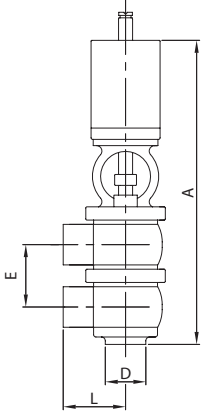

DN	A	D	E	L	gr
25	295,0	25,4	54,0	45,0	4.670
38	320,0	38,1	67,0	56,0	5.100
51	395,0	50,8	80,0	70,0	9.100
63	425,0	63,5	96,0	78,0	11.000
76	469,0	76,2	103,0	85,0	15.100
101	624,0	101,6	171,0	135,0	23.000

V. PNEUM. 3-A 3 V. LT EL.
PNEUM. V. 3-A 3 W. LT PE.
V. PNEUM. 3-A 3 V. LT BL.
V. NEUM. 3-A 3 V. LT EL.

915 L

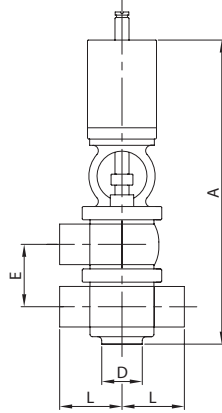

DN	A	D	E	L	gr
25	295,0	25,4	54,0	45,0	4.670
38	320,0	38,1	67,0	56,0	5.100
51	395,0	50,8	80,0	70,0	9.100
63	425,0	63,5	96,0	78,0	11.000
76	469,0	76,2	103,0	85,0	15.100
101	624,0	101,6	171,0	135,0	23.000

V. PNEUM. 3-A 4 V. TL EL.
PNEUM. V. 3-A 4 W. TL PE.
V. PNEUM. 3-A 4 V. TL BL.
V. NEUM. 3-A 4 V. TL EL.

920 L

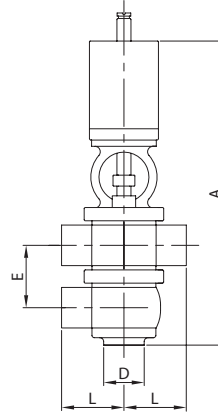

DN	A	D	E	L	gr
25	295,0	25,4	54,0	45,0	4.670
38	320,0	38,1	67,0	56,0	5.100
51	395,0	50,8	80,0	70,0	9.100
63	425,0	63,5	96,0	78,0	11.000
76	469,0	76,2	103,0	85,0	15.100
101	624,0	101,6	171,0	135,0	23.000

V. PNEUM. 3-A 5 V. TT EL.
PNEUM. V. 3-A 5 W. TT PE.
V. PNEUM. 3-A 5 V. TT BL.
V. NEUM. 3-A 5 V. TT EL.

925 L

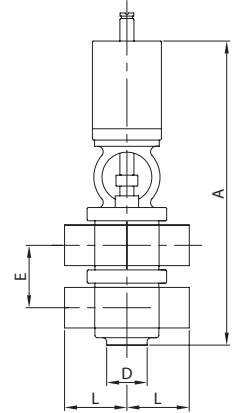

DN	A	D	E	L	gr
25	295,0	25,4	54,0	45,0	4.670
38	320,0	38,1	67,0	56,0	5.100
51	395,0	50,8	80,0	70,0	9.100
63	425,0	63,5	96,0	78,0	11.000
76	469,0	76,2	103,0	85,0	15.100
101	624,0	101,6	171,0	135,0	23.000

V. PNEUM. 3-A 3 V. LL EF.
PNEUM. V. 3-A 3 W. LL ME.
V. PNEUM. 3-A 3 V. LL BF.
V. NEUM. 3-A 3 V. LL ER.

911 B

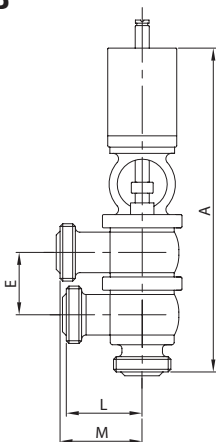

DN	A	E	L	M	gr
25	318,7	54,0	58,0	93,0	5.075
38	343,7	67,0	60,0	95,0	5.595
51	418,7	80,0	73,0	108,0	9.760
63	448,7	96,0	81,0	116,0	11.885
76	492,7	103,0	89,0	124,0	16.165
101	647,7	171,0	158,7	158,7	24.500

V. PNEUM. 3-A 3 V. LT EF.
PNEUM. V. 3-A 3 W. LT ME.
V. PNEUM. 3-A 3 V. LT BF.
V. NEUM. 3-A 3 V. LT ER.

916 B

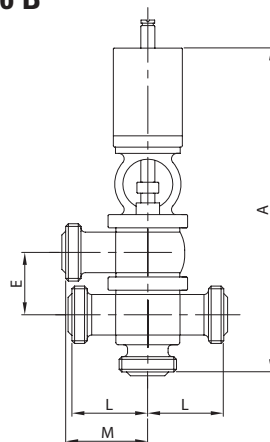

DN	A	E	L	M	gr
25	318,7	54,0	58,0	93,0	5.130
38	343,7	67,0	60,0	95,0	5.760
51	418,7	80,0	73,0	108,0	9.980
63	448,7	96,0	81,0	116,0	12.180
76	492,7	103,0	89,0	124,0	16.520
101	647,7	171,0	158,7	158,7	25.000

V. PNEUM. 3-A 4 V. TL EF.
PNEUM. V. 3-A 4 W. TL ME.
V. PNEUM. 3-A 4 V. TL BF.
V. NEUM. 3-A 4 V. TL ER.

921 B

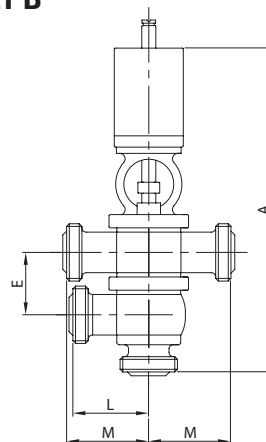

DN	A	E	L	M	gr
25	318,7	54,0	58,0	93,0	5.130
38	343,7	67,0	60,0	95,0	5.760
51	418,7	80,0	73,0	108,0	9.980
63	448,7	96,0	81,0	116,0	12.180
76	492,7	103,0	89,0	124,0	16.520
101	647,7	171,0	158,7	158,7	25.000

V. PNEUM. 3-A 5 V. TT EF.
PNEUM. V. 3-A 5 W. TT ME.
V. PNEUM. 3-A 5 V. TT BF.
V. NEUM. 3-A 5 V. TT ER.

926 B

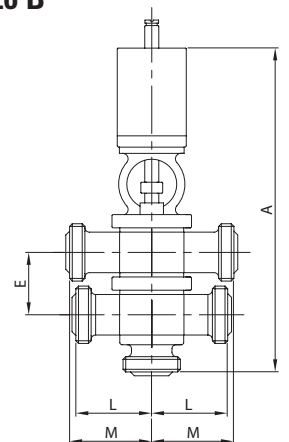

DN	A	E	L	M	gr
25	318,7	54,0	58,0	93,0	5.245
38	343,7	67,0	60,0	95,0	5.925
51	418,7	80,0	73,0	108,0	10.200
63	448,7	96,0	81,0	116,0	12.475
76	492,7	103,0	89,0	124,0	16.815
101	647,7	171,0	158,7	158,7	25.500

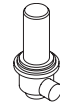

V. MANUALE 2 V. L EL.
MANUAL V. 2 W. L PE.
V. MANUELLE 2 V. L BL.
V. MANUAL 2 V. L EL.

850 L

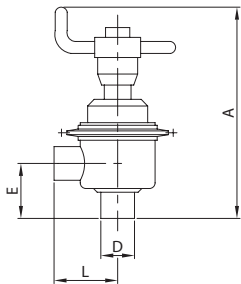

V. MANUALE 3 V. T EL.
MANUAL V. 3 W. T PE.
V. MANUELLE 3 V. T BL.
V. MANUAL 3 V. T EL.

855 L

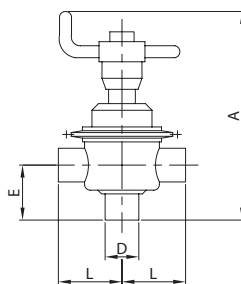

V. MANUALE 3 V. LL EL.
MANUAL V. 3 W. LL PE.
V. MANUELLE 3 V. LL BL.
V. MANUAL 3 V. LL EL.

860 L

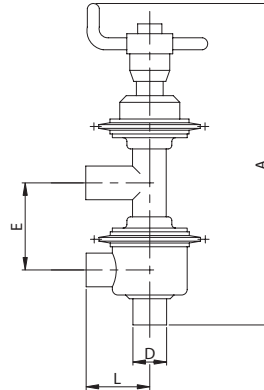

V. MANUALE 4 V. LT EL.
MANUAL V. 4 W. LT PE.
V. MANUELLE 4 V. LT BL.
V. MANUAL 4 V. LT EL.

865 L

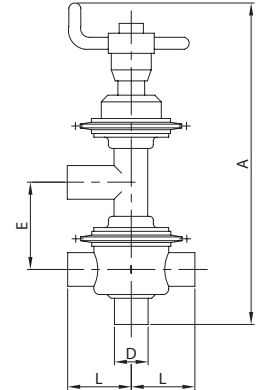

DN	A	D	E	L	gr
25	251,5	25,4	50,5	66,5	2.185
38	251,0	38,1	50,0	66,5	2.180
51	290,0	50,8	58,5	74,0	2.700
63	361,0	63,5	67,5	95,0	4.530
76	372,0	76,2	76,0	95,0	4.740

DN	A	D	E	L	gr
25	251,5	25,4	50,5	66,5	2.200
38	251,0	38,1	50,0	66,5	2.200
51	290,0	50,8	58,5	74,0	2.730
63	361,0	63,5	67,5	95,0	4.700
76	372,0	76,2	76,0	95,0	4.740

DN	A	D	E	L	gr
25	332,5	25,4	81,0	66,5	2.540
38	332,0	38,1	81,0	66,5	2.560
51	385,0	50,8	95,0	74,0	3.230
63	476,0	63,5	115,0	95,0	5.750
76	503,0	76,2	131,0	95,0	5.950

DN	A	D	E	L	gr
25	332,5	25,4	81,0	66,5	2.570
38	332,0	38,1	81,0	66,5	2.600
51	385,0	50,8	95,0	74,0	3.250
63	476,0	63,5	115,0	95,0	5.900
76	503,0	76,2	131,0	95,0	6.200

V. MANUALE 2 V. L EF.
MANUAL V. 2 W. L ME.
V. MANUELLE 2 V. L BF.
V. MANUAL 2 V. L ER.

851 B

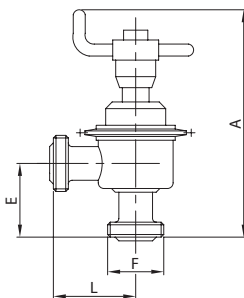

V. MANUALE 3 V. T EF.
MANUAL V. 3 W. T ME.
V. MANUELLE 3 V. T BF.
V. MANUAL 3 V. T ER.

856 B

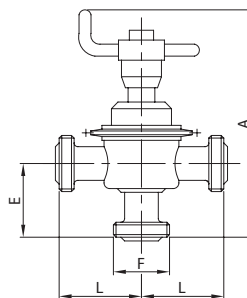

V. MANUALE 3 V. LL EF.
MANUAL V. 3 W. LL ME.
V. MANUELLE 3 V. LL BF.
V. MANUAL 3 V. LL ER.

861 B

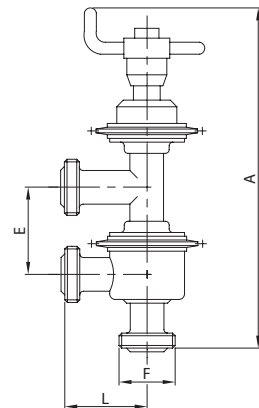

V. MANUALE 4 V. LT EF.
MANUAL V. 4 W. LT ME.
V. MANUELLE 4 V. LT BF.
V. MANUAL 4 V. LT ER.

866 B

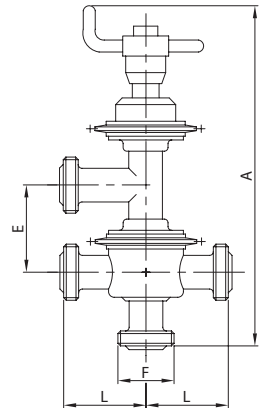

DN	A	E	F	L	gr
25	283,0	69,5	46-8	85,5	2.290
38	282,5	69,0	58-8	85,5	2.340
51	321,5	77,5	73-6	93,0	2.940
63	392,5	86,5	85-6	114,0	4.810
76	403,5	95,0	98-6	114,0	5.100

DN	A	E	F	L	gr
25	283,0	69,5	46-8	85,5	2.300
38	282,5	69,0	58-8	85,5	2.430
51	321,5	77,5	73-6	93,0	3.100
63	392,5	86,5	85-6	114,0	5.150
76	403,5	95,0	98-6	114,0	5.300

DN	A	E	F	L	gr
25	364,0	81,0	46-8	85,5	2.690
38	363,5	81,0	58-8	85,5	2.790
51	416,5	95,0	73-6	93,0	3.590
63	507,5	115,0	85-6	114,0	6.190
76	534,5	131,0	98-6	114,0	6.500

DN	A	E	F	L	gr
25	364,0	81,0	46-8	85,5	2.770
38	363,5	81,0	58-8	85,5	2.900
51	416,5	95,0	73-6	93,0	3.720
63	507,5	115,0	85-6	114,0	6.480
76	534,5	131,0	98-6	114,0	6.930

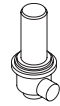

V. PNEUMATICA 2 V. L EL.
PNEUMATIC V. 2 W. L PE.
V. PNEUMATIQUE 2 V. L BL.
V. NEUMÁTICA 2 V. L EL.

800 L

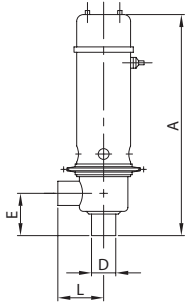

DN	A	D	E	L	gr
25	373,5	25,4	50,5	66,5	4.370
38	373,0	38,1	50,0	66,5	4.360
51	377,5	50,8	58,5	74,0	5.400
63	424,5	63,5	67,5	95,0	9.050
76	435,0	76,2	76,0	95,0	9.470
101	543,0	101,6	98,0	135,0	19.850

V. PNEUMATICA 3 V. T EL.
PNEUMATIC V. 3 W. T PE.
V. PNEUMATIQUE 3 V. T BL.
V. NEUMÁTICA 3 V. T EL.

805 L

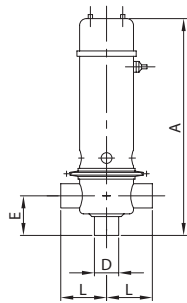

DN	A	D	E	L	gr
25	373,5	25,4	50,5	66,5	4.390
38	373,0	38,1	50,0	66,5	4.400
51	377,5	50,8	58,5	74,0	5.450
63	424,5	63,5	67,5	95,0	9.400
76	435,0	76,2	76,0	95,0	9.480
101	543,0	101,6	98,0	135,0	19.980

V. PNEUMATICA 3 V. LL EL.
PNEUMATIC V. 3 W. LL PE.
V. PNEUMATIQUE 3 V. LL BL.
V. NEUMÁTICA 3 V. LL EL.

810 L

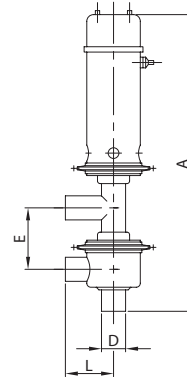

DN	A	D	E	L	gr
25	454,5	25,4	81,0	66,5	5.075
38	454,0	38,1	81,0	66,5	5.110
51	472,5	50,8	95,0	74,0	6.460
63	539,5	63,5	115,0	95,0	11.500
76	566,0	76,2	131,0	95,0	11.900
101	700,0	101,6	157,0	135,0	24.280

V. PNEUMATICA 4 V. LT EL.
PNEUMATIC V. 4 W. LT PE.
V. PNEUMATIQUE 4 V. LT BL.
V. NEUMÁTICA 4 V. LT EL.

815 L

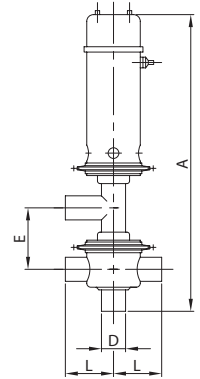

DN	A	D	E	L	gr
25	454,5	25,4	81,0	66,5	5.075
38	454,0	38,1	81,0	66,5	5.110
51	472,5	50,8	95,0	74,0	6.460
63	539,5	63,5	115,0	95,0	11.500
76	566,0	76,2	131,0	95,0	11.900
101	700,0	101,6	157,0	135,0	24.280

V. PNEUMATICA 2 V. L EF.
PNEUMATIC V. 2 W. L ME.
V. PNEUMATIQUE 2 V. L BF.
V. NEUMÁTICA 2 V. L ER.

801 I

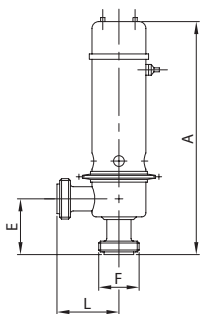

DN	A	E	F	L	gr
25	395,0	72,0	37-8	88,0	4.470
38	394,5	71,5	50-8	88,0	4.560
51	399,0	80,0	64-8	95,5	5.640
63	446,0	89,0	77-8	116,5	9.440
76	456,5	97,5	91-8	116,5	9.990
101	564,5	119,5	118-8	156,5	20.890

V. PNEUMATICA 3 V. T EF.
PNEUMATIC V. 3 W. T ME.
V. PNEUMATIQUE 3 V. T BF.
V. NEUMÁTICA 3 V. T ER.

806 I

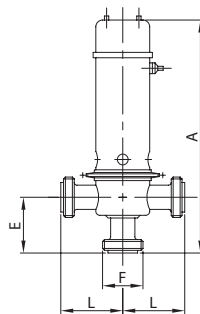

DN	A	E	F	L	gr
25	395,0	72,0	37-8	88,0	4.540
38	394,5	71,5	50-8	88,0	4.700
51	399,0	80,0	64-8	95,5	5.810
63	446,0	89,0	77-8	116,5	9.985
76	456,5	97,5	91-8	116,5	10.260
101	564,5	119,5	118-8	156,5	21.540

V. PNEUMATICA 3 V. LL EF.
PNEUMATIC V. 3 W. LL ME.
V. PNEUMATIQUE 3 V. LL BF.
V. NEUMÁTICA 3 V. LL ER.

811 I

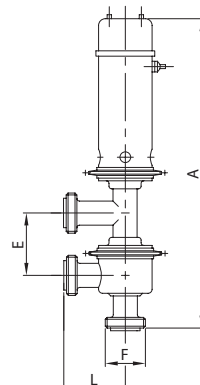

DN	A	E	F	L	gr
25	476,0	81,0	37-8	88,0	5.225
38	475,5	81,0	50-8	88,0	5.410
51	494,0	95,0	64-8	95,5	6.820
63	561,0	115,0	77-8	116,5	12.085
76	587,5	131,0	91-8	116,5	12.688
101	721,5	157,0	118-8	156,5	25.840

V. PNEUMATICA 4 V. LT EF.
PNEUMATIC V. 4 W. LT ME.
V. PNEUMATIQUE 4 V. LT BF.
V. NEUMÁTICA 4 V. LT ER.

816 I

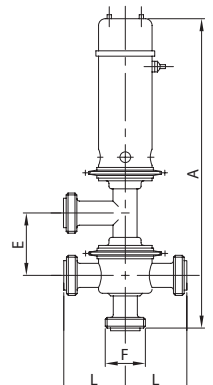

DN	A	E	F	L	gr
25	476,0	81,0	37-8	88,0	5.225
38	475,5	81,0	50-8	88,0	5.410
51	494,0	95,0	64-8	95,5	6.820
63	561,0	115,0	77-8	116,5	12.085
76	587,5	131,0	91-8	116,5	12.688
101	721,5	157,0	118-8	156,5	25.840

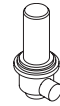

V. PNEUMATICA 4 V. TL EL.
PNEUMATIC V. 4 W. TL PE.
V. PNEUMATIQUE 4 V. TL BL.
V. NEUMÁTICA 4 V. TL EL.

820 L

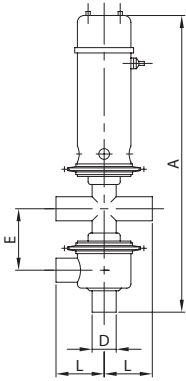

DN	A	D	E	L	gr
25	454,5	25,4	81,0	66,5	5.140
38	454,0	38,1	81,0	66,5	5.190
51	472,5	50,8	95,0	74,0	6.500
63	539,5	63,5	115,0	95,0	11.800
76	566,0	76,2	131,0	95,0	12.400
101	700,0	101,6	157,0	135,0	24.450

V. PNEUMATICA 5 V. TT EL.
PNEUMATIC V. 5 W. TT PE.
V. PNEUMATIQUE 5 V. TT BL.
V. NEUMÁTICA 5 V. TT BL.

825 L

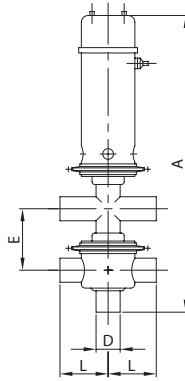

DN	A	D	E	L	gr
25	454,5	25,4	81,0	66,5	5.140
38	454,0	38,1	81,0	66,5	5.190
51	472,5	50,8	95,0	74,0	6.500
63	539,5	63,5	115,0	95,0	11.800
76	566,0	76,2	131,0	95,0	12.400
101	700,0	101,6	157,0	135,0	24.450

V. PNEUM. 3-A 2 V. L EL.
PNEUM. V. 3-A 2 W. L PE.
V. PNEUM. 3-A 2 V. L BL.
V. NEUM. 3-A 2 V. L EL.

900 L

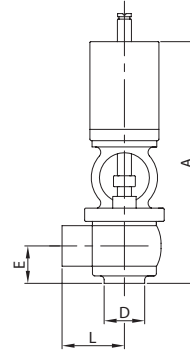

DN	A	D	E	L	gr
25	241,0	25,4	38,0	45,0	3.510
38	253,0	38,1	43,5	56,0	3.720
51	315,0	50,8	53,0	70,0	6.500
63	329,0	63,5	57,0	78,0	8.250
76	366,0	76,2	65,5	85,0	10.850
101	453,0	101,6	90,5	135,0	19.200

V. PNEUM. 3-A 3 V. T EL.
PNEUM. V. 3-A 3 W. T PE.
V. PNEUM. 3-A 3 V. T BL.
V. NEUM. 3-A 3 V. T EL.

905 L

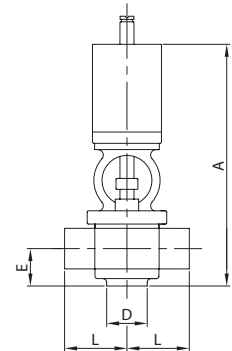

DN	A	D	E	L	gr
25	241,0	25,4	38,0	45,0	3.510
38	253,0	38,1	43,5	56,0	3.720
51	315,0	50,8	53,0	70,0	6.500
63	329,0	63,5	57,0	78,0	8.250
76	366,0	76,2	65,5	85,0	10.850
101	453,0	101,6	90,5	135,0	19.200

V. PNEUMATICA 4 V. TL EF.
PNEUMATIC V. 4 W. TL ME.
V. PNEUMATIQUE 4 V. TL BF.
V. NEUMÁTICA 4 V. TL ER.

821 I

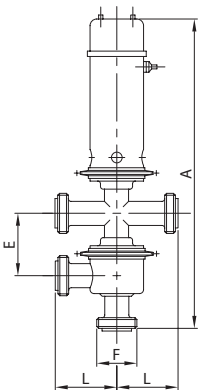

DN	A	E	F	L	gr
25	476,0	81,0	37-8	88,0	5.340
38	475,5	81,0	50-8	88,0	5.590
51	494,0	95,0	64-8	95,5	6.980
63	561,0	115,0	77-8	116,5	12.580
76	587,5	131,0	91-8	116,5	13.440
101	721,5	157,0	118-8	156,5	26.530

V. PNEUMATICA 5 V. TT EF.
PNEUMATIC V. 5 W. TT ME.
V. PNEUMATIQUE 5 V. TT BF.
V. NEUMÁTICA 5 V. TT ER.

826 I

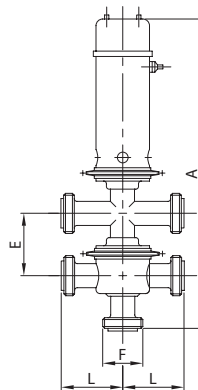

DN	A	E	F	L	gr
25	476,0	81,0	37-8	88,0	5.340
38	475,5	81,0	50-8	88,0	5.590
51	494,0	95,0	64-8	95,5	6.980
63	561,0	115,0	77-8	116,5	12.580
76	587,5	131,0	91-8	116,5	13.440
101	721,5	157,0	118-8	156,5	26.530

V. PNEUM. 3-A 2 V. L EF.
PNEUM. V. 3-A 2 W. L ME.
V. PNEUM. 3-A 2 V. L BF.
V. NEUM. 3-A 2 V. L ER.

901 I

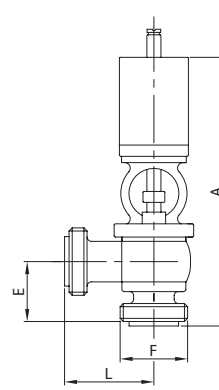

DN	A	E	F	L	gr
25	252,5	59,5	37-8	61,0	3.650
38	274,5	65,0	50-8	63,0	3.940
51	336,5	74,5	64-8	76,0	6.800
63	350,5	78,5	77-8	84,0	8.670
76	387,5	87,0	91-8	92,0	11.390
101	474,5	112,0	118-8	156,5	20.040

V. PNEUM. 3-A 3 V. T EF.
PNEUM. V. 3-A 3 W. T ME.
V. PNEUM. 3-A 3 V. T BF.
V. NEUM. 3-A 3 V. T ER.

906 I

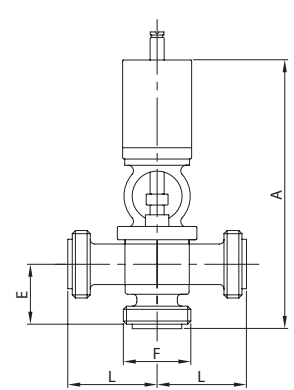

DN	A	E	F	L	gr
25	252,5	59,5	37-8	61,0	3.720
38	274,5	65,0	50-8	63,0	4.050
51	336,5	74,5	64-8	76,0	6.950
63	350,5	78,5	77-8	84,0	8.880
76	387,5	87,0	91-8	92,0	11.660
101	474,5	112,0	118-8	156,5	20.460

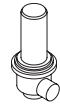

V. PNEUM. 3-A 3 V. LL EL.
PNEUM. V. 3-A 3 W. LL PE.
V. PNEUM. 3-A 3 V. LL BL.
V. NEUM. 3-A 3 V. LL EL.

910 L

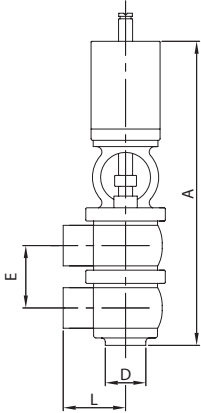

DN	A	D	E	L	gr
25	295,0	25,4	54,0	45,0	4.670
38	320,0	38,1	67,0	56,0	5.100
51	395,0	50,8	80,0	70,0	9.100
63	425,0	63,5	96,0	78,0	11.000
76	469,0	76,2	103,0	85,0	15.100
101	624,0	101,6	171,0	135,0	23.000

V. PNEUM. 3-A 3 V. LT EL.
PNEUM. V. 3-A 3 W. LT PE.
V. PNEUM. 3-A 3 V. LT BL.
V. NEUM. 3-A 3 V. LT EL.

915 L

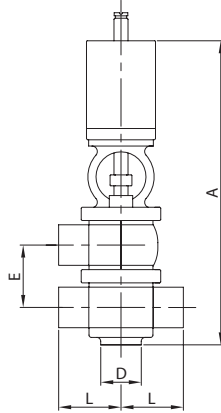

DN	A	D	E	L	gr
25	295,0	25,4	54,0	45,0	4.670
38	320,0	38,1	67,0	56,0	5.100
51	395,0	50,8	80,0	70,0	9.100
63	425,0	63,5	96,0	78,0	11.000
76	469,0	76,2	103,0	85,0	15.100
101	624,0	101,6	171,0	135,0	23.000

V. PNEUM. 3-A 4 V. TL EL.
PNEUM. V. 3-A 4 W. TL PE.
V. PNEUM. 3-A 4 V. TL BL.
V. NEUM. 3-A 4 V. TL EL.

920 L

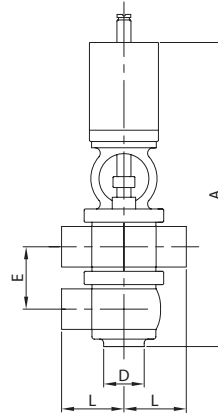

DN	A	D	E	L	gr
25	295,0	25,4	54,0	45,0	4.670
38	320,0	38,1	67,0	56,0	5.100
51	395,0	50,8	80,0	70,0	9.100
63	425,0	63,5	96,0	78,0	11.000
76	469,0	76,2	103,0	85,0	15.100
101	624,0	101,6	171,0	135,0	23.000

V. PNEUM. 3-A 5 V. TT EL.
PNEUM. V. 3-A 5 W. TT PE.
V. PNEUM. 3-A 5 V. TT BL.
V. NEUM. 3-A 5 V. TT EL.

925 L

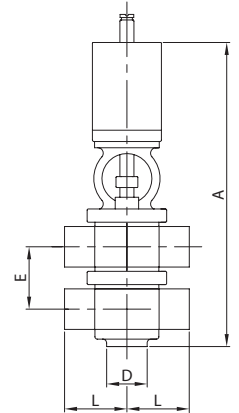

DN	A	D	E	L	gr
25	295,0	25,4	54,0	45,0	4.670
38	320,0	38,1	67,0	56,0	5.100
51	395,0	50,8	80,0	70,0	9.100
63	425,0	63,5	96,0	78,0	11.000
76	469,0	76,2	103,0	85,0	15.100
101	624,0	101,6	171,0	135,0	23.000

V. PNEUM. 3-A 3 V. LL EF.
PNEUM. V. 3-A 3 W. LL ME.
V. PNEUM. 3-A 3 V. LL BF.
V. NEUM. 3-A 3 V. LL ER.

911 I

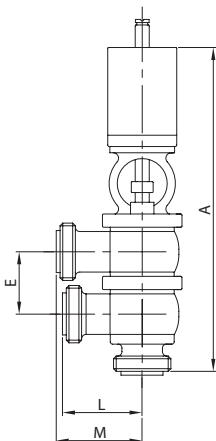

DN	A	E	L	M	gr
25	316,5	54,0	61,0	96,0	4.880
38	341,5	67,0	63,0	98,0	5.430
51	416,5	80,0	76,0	111,0	9.550
63	446,5	96,0	84,0	119,0	11.630
76	490,5	103,0	92,0	127,0	15.910
101	645,5	171,0	156,5	156,5	24.260

V. PNEUM. 3-A 3 V. LT EF.
PNEUM. V. 3-A 3 W. LT ME.
V. PNEUM. 3-A 3 V. LT BF.
V. NEUM. 3-A 3 V. LT ER.

916 I

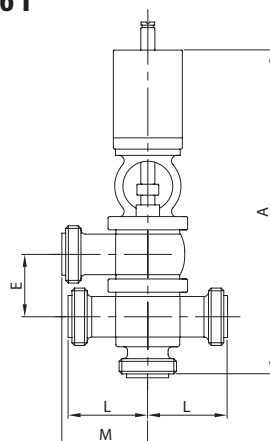

DN	A	E	L	M	gr
25	316,5	54,0	61,0	96,0	4.950
38	341,5	67,0	63,0	98,0	5.540
51	416,5	80,0	76,0	111,0	9.700
63	446,5	96,0	84,0	119,0	11.840
76	490,5	103,0	92,0	127,0	16.180
101	645,5	171,0	156,5	156,5	24.680

V. PNEUM. 3-A 4 V. TL EF.
PNEUM. V. 3-A 4 W. TL ME.
V. PNEUM. 3-A 4 V. TL BF.
V. NEUM. 3-A 4 V. TL ER.

921 I

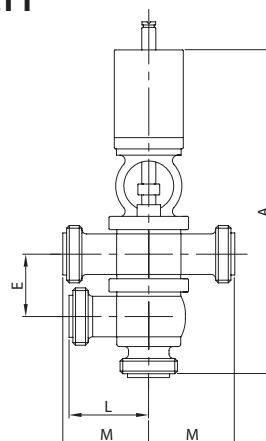

DN	A	E	L	M	gr
25	316,5	54,0	61,0	96,0	4.950
38	341,5	67,0	63,0	98,0	5.540
51	416,5	80,0	76,0	111,0	9.700
63	446,5	96,0	84,0	119,0	11.840
76	490,5	103,0	92,0	127,0	16.180
101	645,5	171,0	156,5	156,5	24.680

V. PNEUM. 3-A 5 V. TT EF.
PNEUM. V. 3-A 5 W. TT ME.
V. PNEUM. 3-A 5 V. TT BF.
V. NEUM. 3-A 5 V. TT ER.

926 I

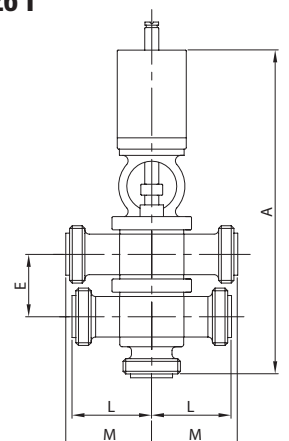

DN	A	E	L	M	gr
25	316,5	54,0	61,0	96,0	5.020
38	341,5	67,0	63,0	98,0	5.650
51	416,5	80,0	76,0	111,0	9.850
63	446,5	96,0	84,0	119,0	12.050
76	490,5	103,0	92,0	127,0	16.450
101	645,5	171,0	156,5	156,5	25.100

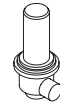

V. MANUALE 2 V. L EL.
MANUAL V. 2 W. L PE.
V. MANUELLE 2 V. L BL.
V. MANUAL 2 V. L EL.

850 L

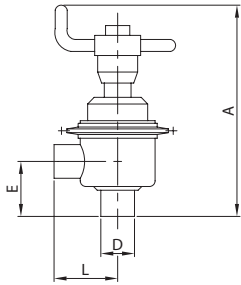

DN	A	D	E	L	gr
25	251,5	25,4	50,5	66,5	2.185
38	251,0	38,1	50,0	66,5	2.180
51	290,0	50,8	58,5	74,0	2.700
63	361,0	63,5	67,5	95,0	4.530
76	372,0	76,2	76,0	95,0	4.740

V. MANUALE 3 V. T EL.
MANUAL V. 3 W. T PE.
V. MANUELLE 3 V. T BL.
V. MANUAL 3 V. T EL.

855 L

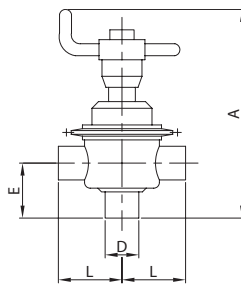

DN	A	D	E	L	gr
25	251,5	25,4	50,5	66,5	2.200
38	251,0	38,1	50,0	66,5	2.200
51	290,0	50,8	58,5	74,0	2.730
63	361,0	63,5	67,5	95,0	4.700
76	372,0	76,2	76,0	95,0	4.740

V. MANUALE 3 V. LL EL.
MANUAL V. 3 W. LL PE.
V. MANUELLE 3 V. LL BL.
V. MANUAL 3 V. LL EL.

860 L

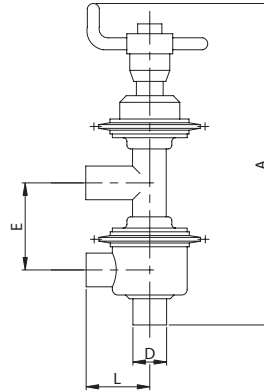

DN	A	D	E	L	gr
25	332,5	25,4	81,0	66,5	2.540
38	332,0	38,1	81,0	66,5	2.560
51	385,0	50,8	95,0	74,0	3.230
63	476,0	63,5	115,0	95,0	5.750
76	503,0	76,2	131,0	95,0	5.950

V. MANUALE 4 V. LT EL.
MANUAL V. 4 W. LT PE.
V. MANUELLE 4 V. LT BL.
V. MANUAL 4 V. LT EL.

865 L

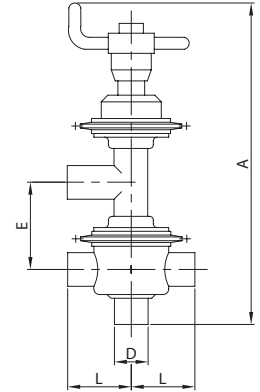

DN	A	D	E	L	gr
25	332,5	25,4	81,0	66,5	2.570
38	332,0	38,1	81,0	66,5	2.600
51	385,0	50,8	95,0	74,0	3.250
63	476,0	63,5	115,0	95,0	5.900
76	503,0	76,2	131,0	95,0	6.200

V. MANUALE 2 V. L EF.
MANUAL V. 2 W. L ME.
V. MANUELLE 2 V. L BF.
V. MANUAL 2 V. L ER.

851 I

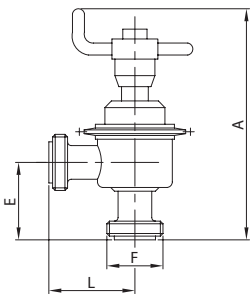

DN	A	E	F	L	gr
25	273,0	72,0	37-8	88,0	2.240
38	272,5	71,5	50-8	88,0	2.280
51	311,5	80,0	64-8	95,5	2.820
63	382,5	89,0	77-8	116,5	4.720
76	393,5	97,5	91-8	116,5	5.000

V. MANUALE 3 V. T EF.
MANUAL V. 3 W. T ME.
V. MANUELLE 3 V. T BF.
V. MANUAL 3 V. T ER.

856 I

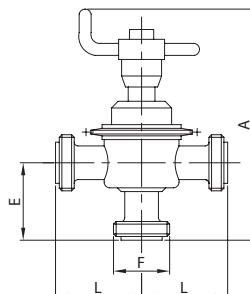

DN	A	E	F	L	gr
25	273,0	72,0	37-8	88,0	2.270
38	272,5	71,5	50-8	88,0	2.350
51	311,5	80,0	64-8	95,5	2.900
63	382,5	89,0	77-8	116,5	4.990
76	393,5	97,5	91-8	116,5	5.130

V. MANUALE 3 V. LL EF.
MANUAL V. 3 W. LL ME.
V. MANUELLE 3 V. LL BF.
V. MANUAL 3 V. LL ER.

861 I

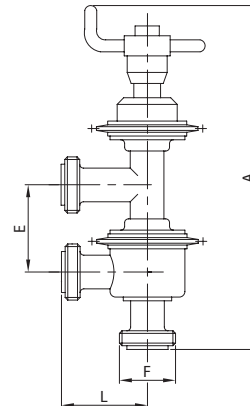

DN	A	E	F	L	gr
25	354,0	81,0	37-8	88,0	2.600
38	353,5	81,0	50-8	88,0	2.700
51	406,5	95,0	64-8	95,5	3.400
63	497,5	115,0	77-8	116,5	6.050
76	524,5	131,0	91-8	116,5	6.340

V. MANUALE 4 V. LT EF.
MANUAL V. 4 W. LT ME.
V. MANUELLE 4 V. LT BF.
V. MANUAL 4 V. LT ER.

866 I

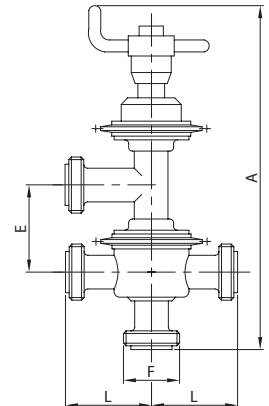

DN	A	E	F	L	gr
25	354,0	81,0	37-8	88,0	2.670
38	353,5	81,0	50-8	88,0	2.800
51	406,5	95,0	64-8	95,5	3.490
63	497,5	115,0	77-8	116,5	6.290
76	524,5	131,0	91-8	116,5	6.720

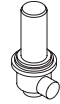

ELETTROVALVOLA NC.
SOLENOID VALVE NC.
ÉLECTROVANNE NF.
ELECTROVÁLVULA NC.

015 NC

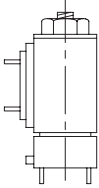

ELETTROVALVOLA NA.
SOLENOID VALVE NO.
ÉLECTROVANNE NO.
ELECTROVÁLVULA NA.

015 NA

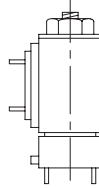

CONTATTO DI PROSSIMITÀ
PROXIMITY CONTACT
CONTACT DE PROXIMITÉ
MICROSENSOR

013 A
013 A/N
013 A/N/EX



CONTATTO DI PROSSIMITÀ
PROXIMITY CONTACT
CONTACT DE PROXIMITÉ
MICROSENSOR

013 S

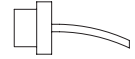

MICROINTERRUTTORE
MICROSWITCH
MINIRUPTEUR
MICRORRUPTOR

014 1

014 2

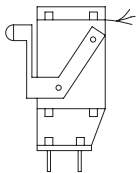

CONNETTORE
CONNECTOR
CONNECTEUR
CONECTOR

030 H

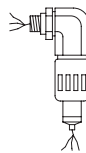

CONNETTORE
CONNECTOR
CONNECTEUR
CONECTOR

030 S

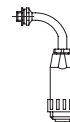

UNITÀ DI CONTROLLO
CONTROL UNIT
UNITÉ DE CONTRÔLE
UNIDAD DE CONTROL

900 UC 4

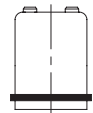

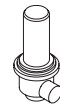

V. PN. DRENAG. 2 V. LL EL.
DRAIN. PN. V. 2 W. LL PE.
V. PN. DRAINAGE 2 V. LL BL.
V. PN. DRENAJE 2 V. LL EL.

830 DL

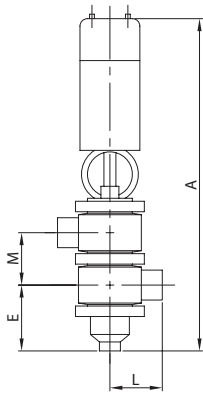

DN	A	E	L	M	gr
51	586,0	103,0	75,0	79,0	16.500
63	646,0	108,0	90,0	91,0	21.500
76	680,0	118,0	95,0	110,0	25.000

V. PN. DRENAG. 3 V. LT EL.
DRAIN. PN. V. 3 W. LT PE.
V. PN. DRAINAGE 3 V. LT BL.
V. PN. DRENAJE 3 V. LT EL.

832 DL

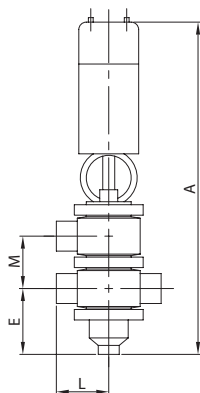

DN	A	E	L	M	gr
51	586,0	103,0	75,0	79,0	16.600
63	646,0	108,0	90,0	91,0	21.700
76	680,0	118,0	95,0	110,0	25.200

V. PN. DRENAG. 3 V. TL EL.
DRAIN. PN. V. 3 W. TL PE.
V. PN. DRAINAGE 3 V. TL BL.
V. PN. DRENAJE 3 V. TL EL.

835 DL

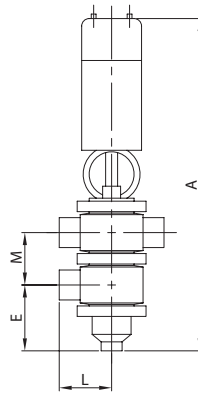

DN	A	E	L	M	gr
51	586,0	103,0	75,0	79,0	16.600
63	646,0	108,0	90,0	91,0	21.700
76	680,0	118,0	95,0	110,0	25.200

V. PN. DRENAG. 3 V. LLL EL.
DRAIN. PN. V. 3 W. LLL PE.
V. PN. DRAIN. 3 V. LLL BL.
V. PN. DRENAJE 3 V. LLL EL.

840 DL

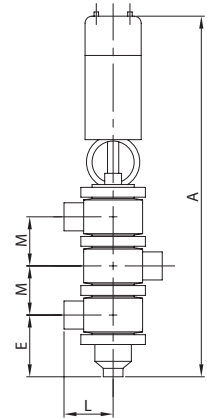

DN	A	E	L	M	gr
51	665,0	103,0	75,0	79,0	14.400
63	737,0	108,0	90,0	91,0	18.400
76	790,0	118,0	95,0	110,0	22.000

V. PN. DRENAG. 4 V. TT EL.
DRAIN. PN. V. 4 W. TT PE.
V. PN. DRAINAGE 4 V. TT BL.
V. PN. DRENAJE 4 V. TT EL.

836 DL

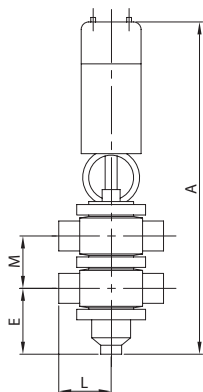

DN	A	E	L	M	gr
51	586,0	103,0	75,0	79,0	16.700
63	646,0	108,0	90,0	91,0	22.000
76	680,0	118,0	95,0	110,0	25.500

V. PN. DRENAG. 4 V. TLL EL.
DRAIN. PN. V. 4 W. TLL PE.
V. PN. DRAIN. 4 V. TLL BL.
V. PN. DRENAJE 4 V. TLL EL.

842 DL

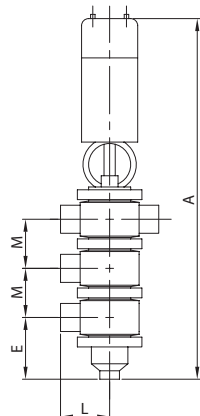

DN	A	E	L	M	gr
51	665,0	103,0	75,0	79,0	14.400
63	737,0	108,0	90,0	91,0	18.400
76	790,0	118,0	95,0	110,0	22.000

V. PN. DRENAG. 5 V. TTL EL.
DRAIN. PN. V. 5 W. TTL PE.
V. PN. DRAIN. 5 V. TTL BL.
V. PN. DRENAJE 5 V. TTL EL.

844 DL

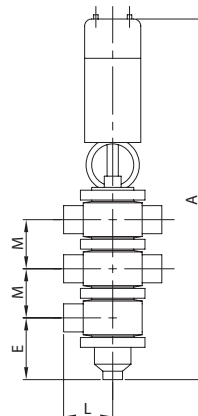

DN	A	E	L	M	gr
51	665,0	103,0	75,0	79,0	14.500
63	737,0	108,0	90,0	91,0	18.500
76	790,0	118,0	95,0	110,0	22.000

V. PN. DRENAG. 6 V. TTT EL.
DRAIN. PN. V. 6 W. TTT PE.
V. PN. DRAIN. 6 V. TTT BL.
V. PN. DRENAJE 6 V. TTT EL.

846 DL

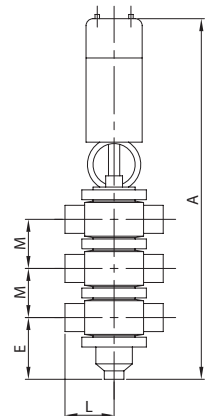

DN	A	E	L	M	gr
51	665,0	103,0	75,0	79,0	14.600
63	737,0	108,0	90,0	91,0	18.700
76	790,0	118,0	95,0	110,0	22.200